

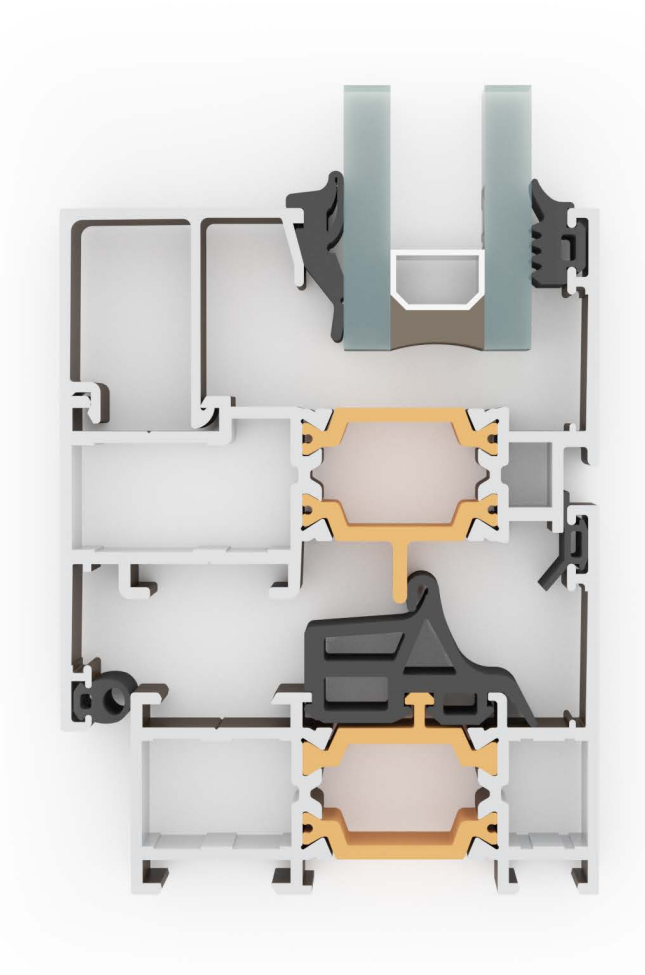

Aluminium Fabrication Products

Door & Window System Technical Catalog

کاتالوگ فنی سیستم های در و پنجره





EXALCO
Aluminium Fabrication Products

- Made
- in
- IRAN

درو پنجره (سیستم لولایی)

Door & Window

W60

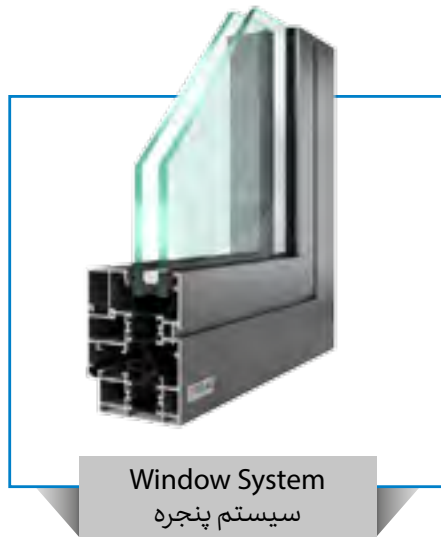

Window System
سیستم پنجره



Hidding Sash System
سیستم مخفی

W70



Window System
سیستم پنجره



Hidding Sash System
سیستم مخفی

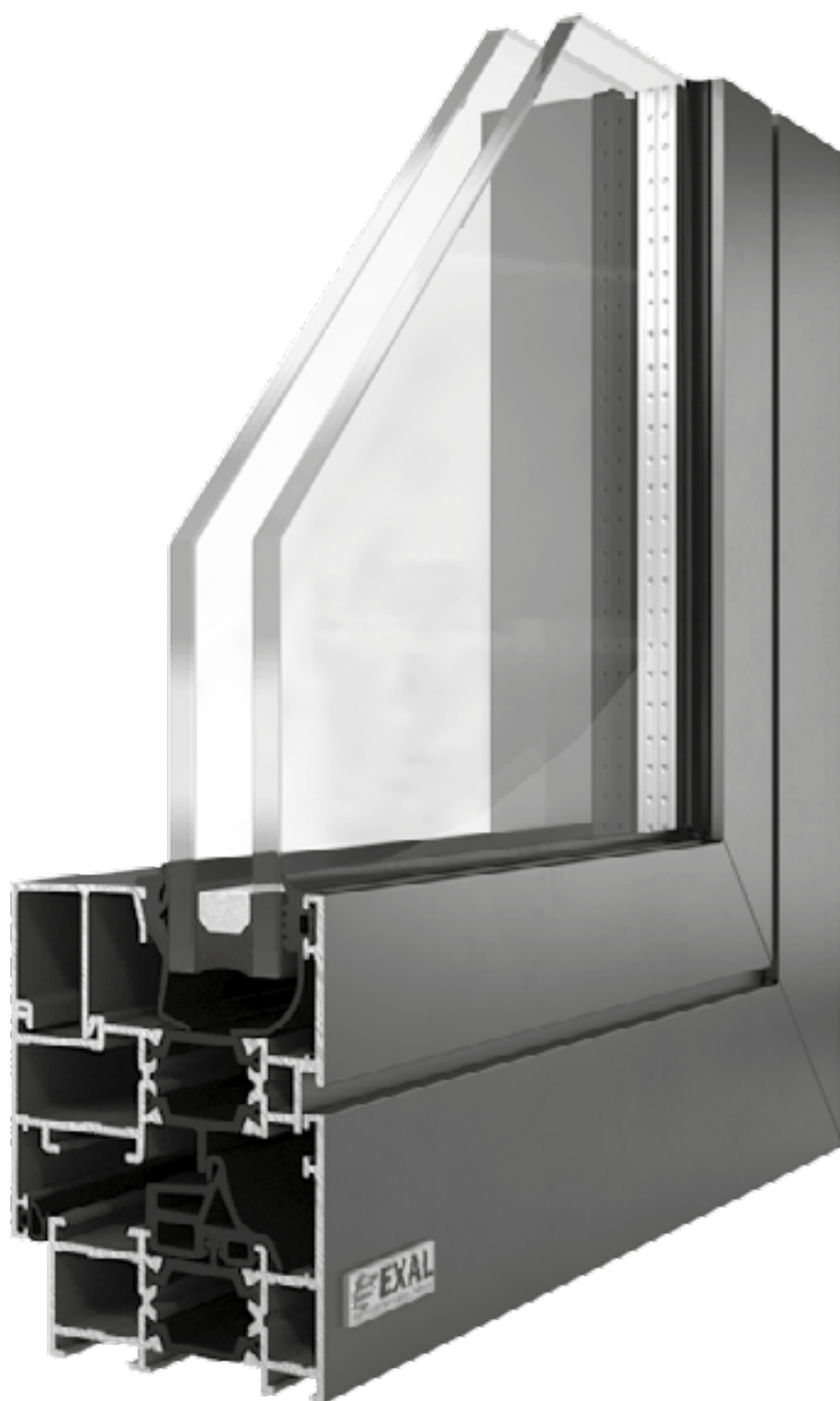

Profile No.	Weight (kg/m)	Static Value
کد پروفیل	وزن پروفیل	Jx (cm ⁴) Jy (cm ⁴)
W60 1000-15	1.198 kg/m	12.60 / 4.86
W60 1001-15	1.405 kg/m	15.39 / 10.74
W60 1002-15	1.440 kg/m	16.37 / 14.41
W60 1003-15	1.615 kg/m	18.18 / 20.25

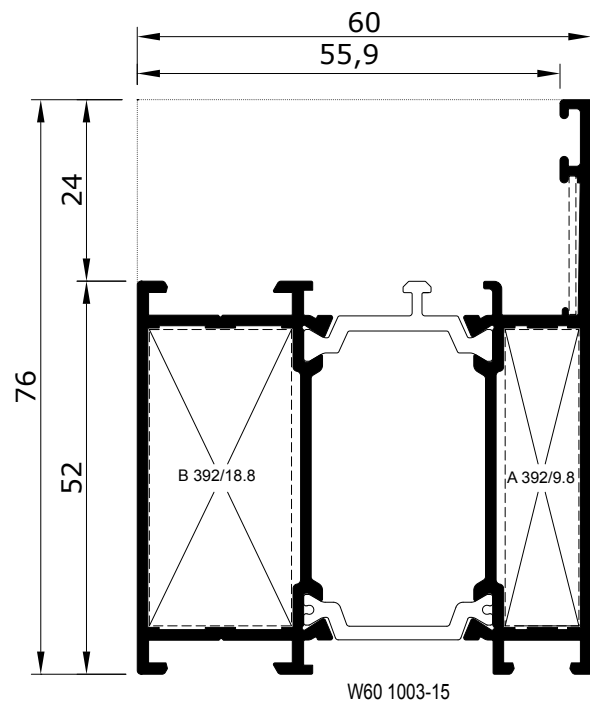
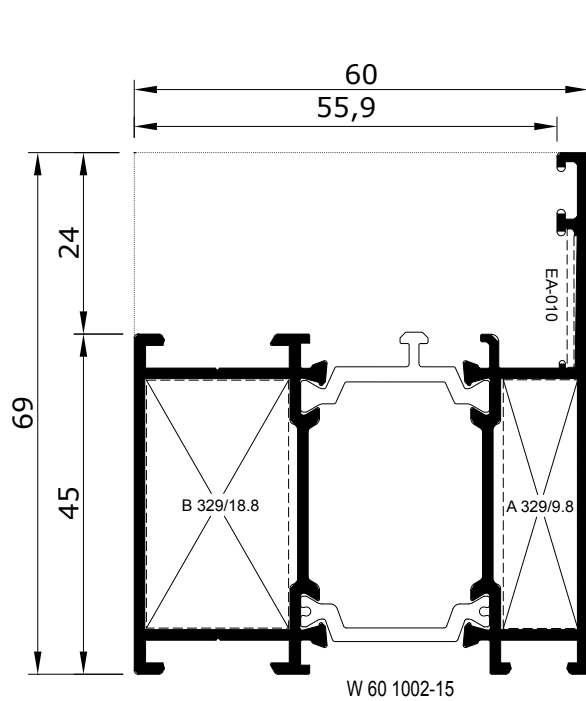
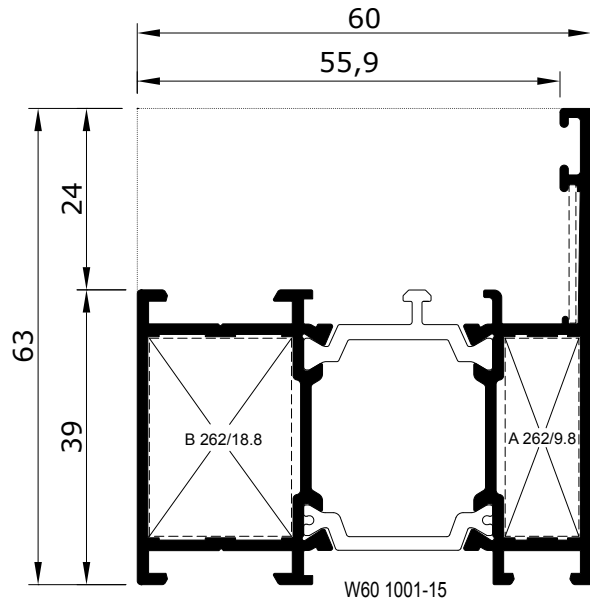
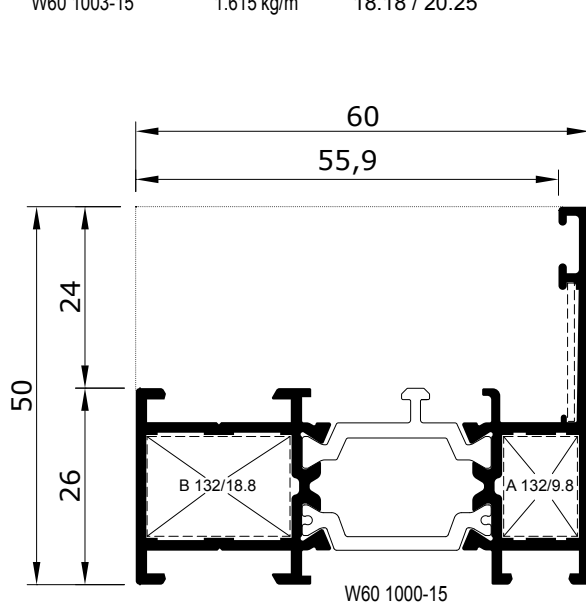

Profile No.	Weight (kg/m)	Static Value
کد پروفیل	وزن پروفیل	Jx (cm ⁴) Jy (cm ⁴)
W60 1005-15	1.345 kg/m	14.47 / 8.54
W60 1006-15	1.554 kg/m	17.34 / 16.25
W60 1009-15	1.764 kg/m	20.18 / 27.93

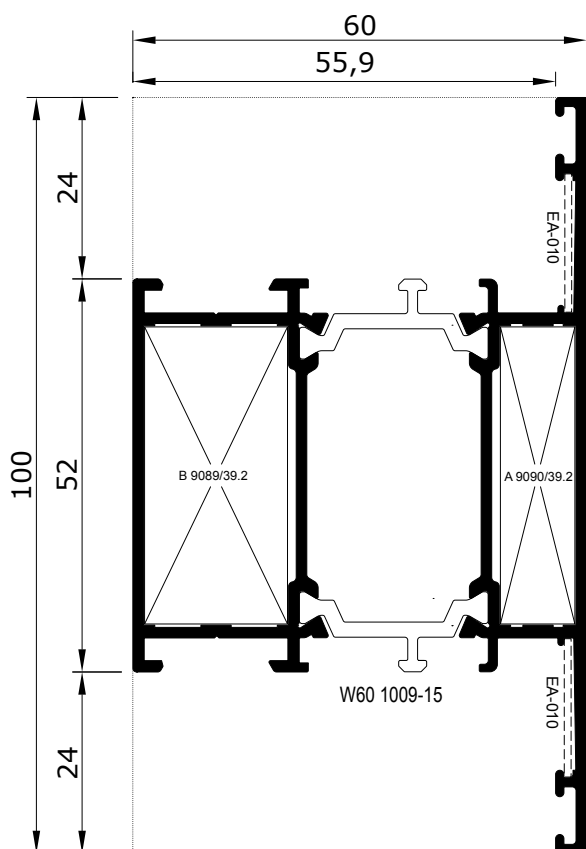
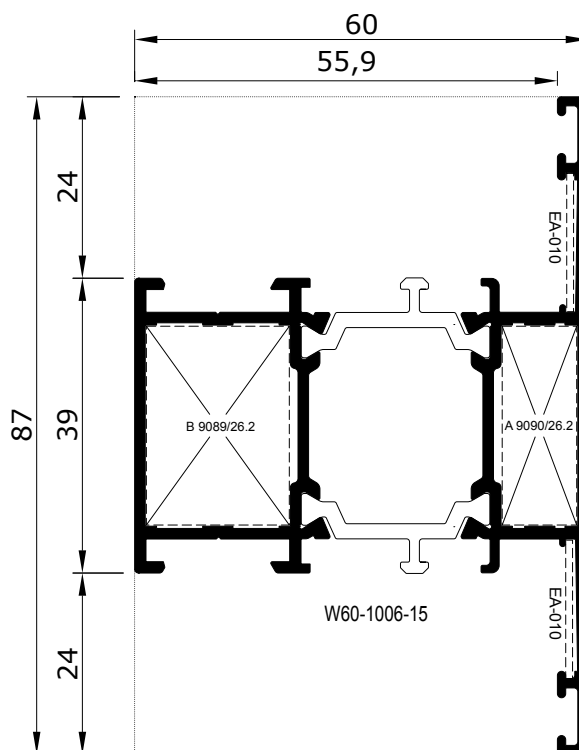
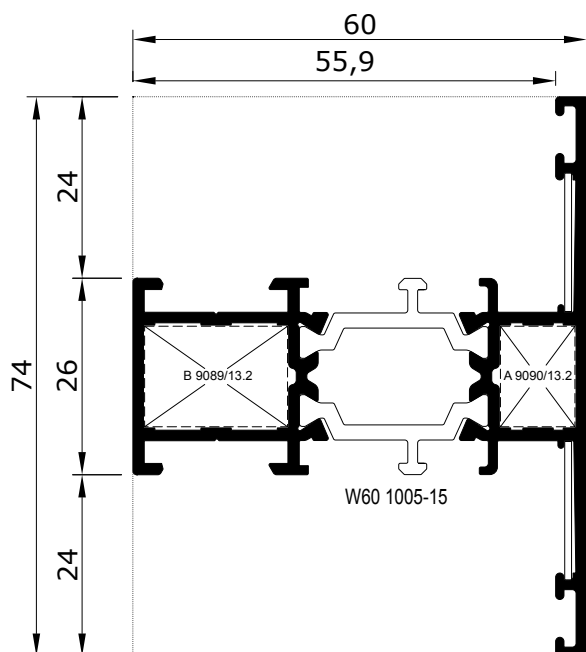

Profile No.	Weight (kg/m)	Static Value
کد پروفیل	وزن پروفیل	Jx (cm ⁴) Jy (cm ⁴)
W60 1010-15	2.216 kg/m	70.17 / 17.94
W60 1011-15	2.576 kg/m	139.16 / 25.74

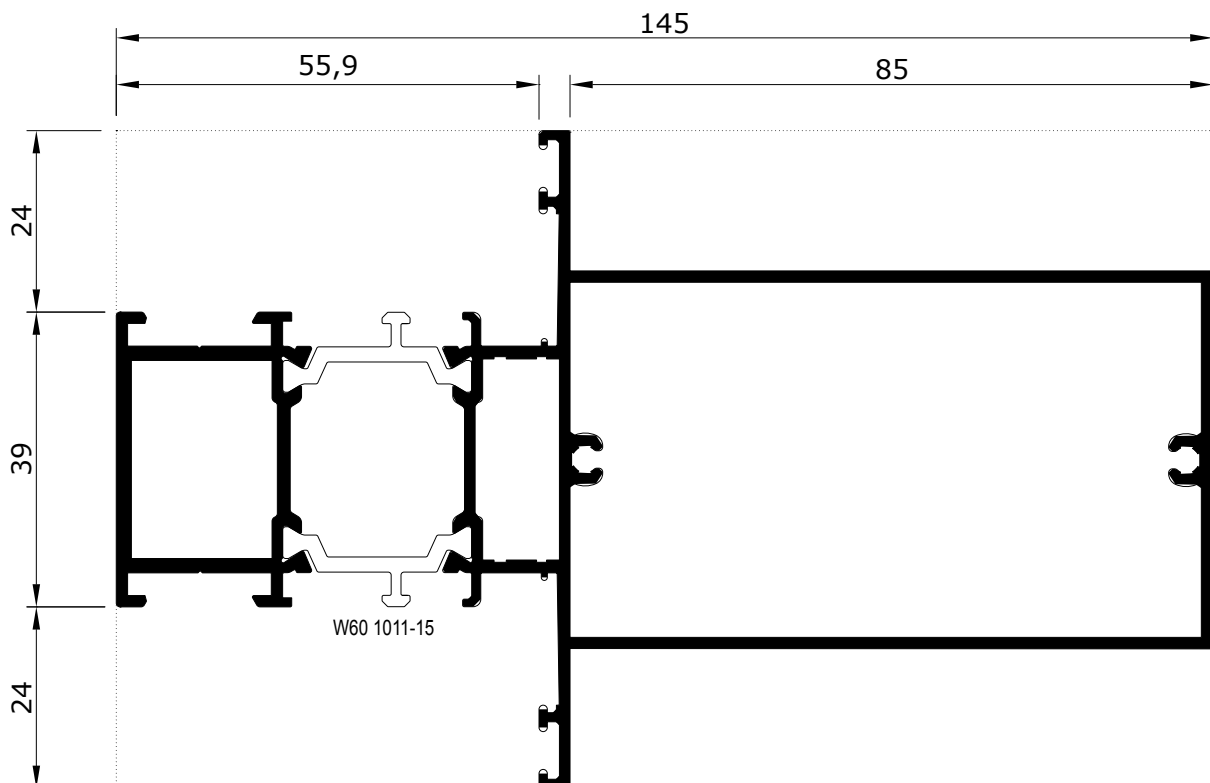
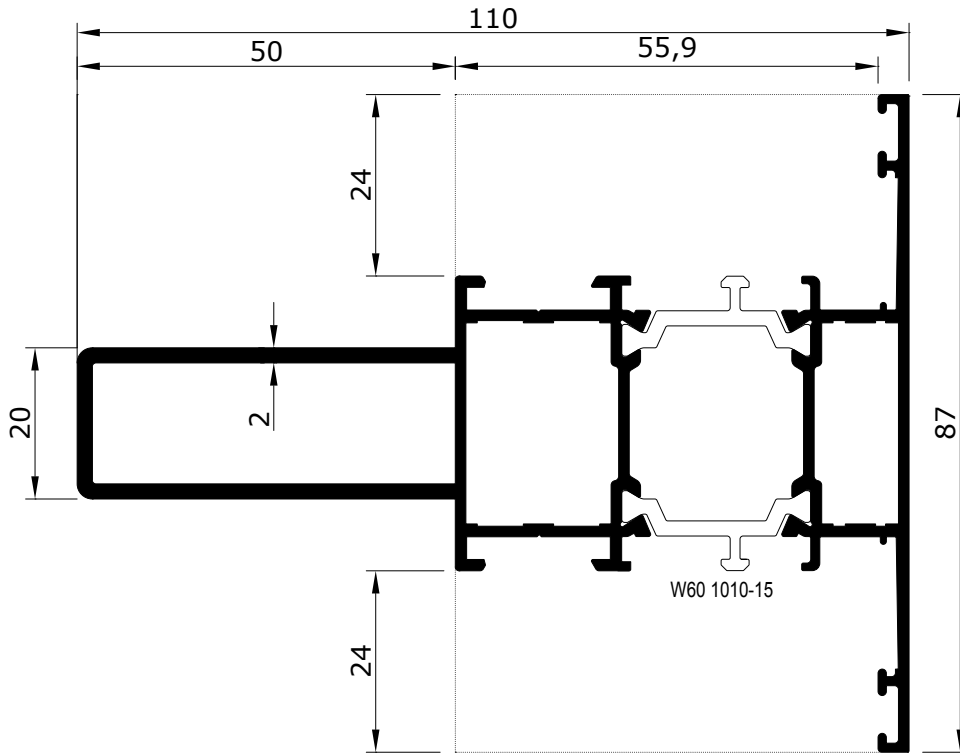

Profile No.	Weight (kg/m)	Static Value
کد پروفیل	وزن پروفیل	Jx (cm ⁴) Jy (cm ⁴)
W60 1007-15	1.460 kg/m	15.87 / 8.60
W60 1008-15	1.663 kg/m	18.66 / 16.53
W60 1046-20	2.338 kg/m	27.91 / 31.23

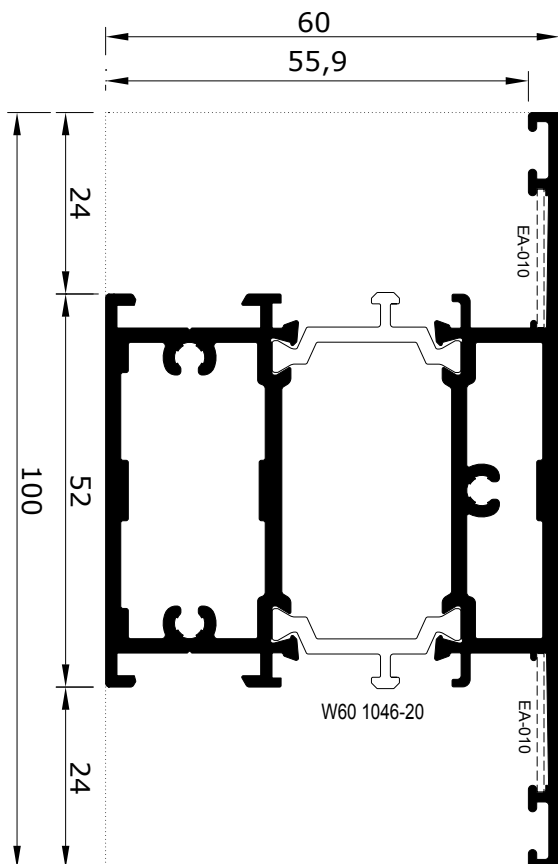
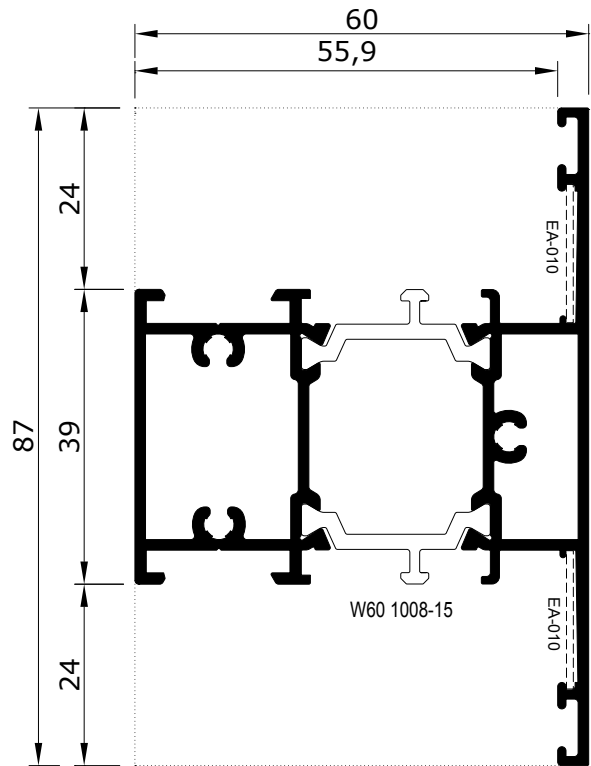
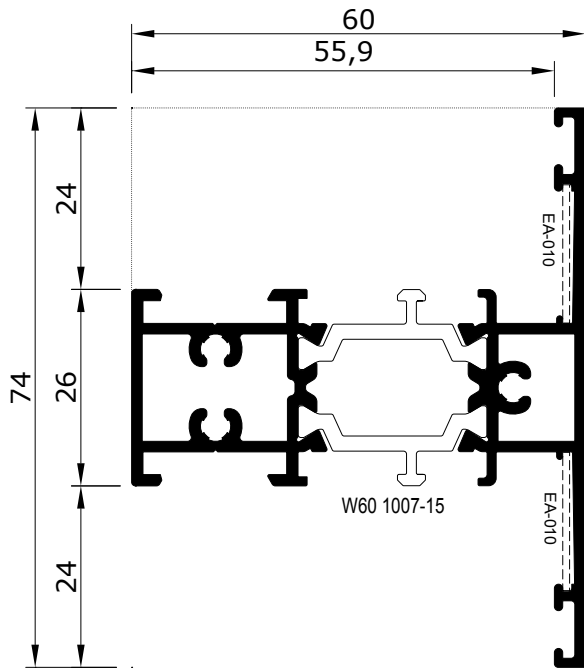

Profile No.	Weight (kg/m)	Static Value
کد پروفیل	وزن پروفیل	Jx (cm ⁴) Jy (cm ⁴)
W60 1012-15	2.181 kg/m	25.83 / 65.66
W60 1013-15	2.244 kg/m	34.74 / 68.09

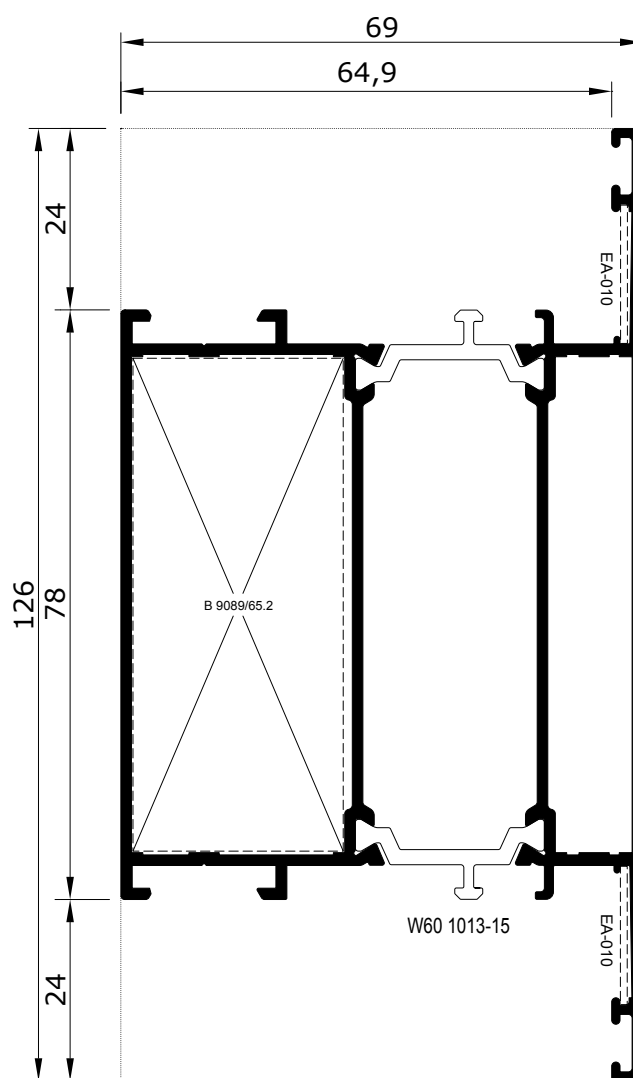
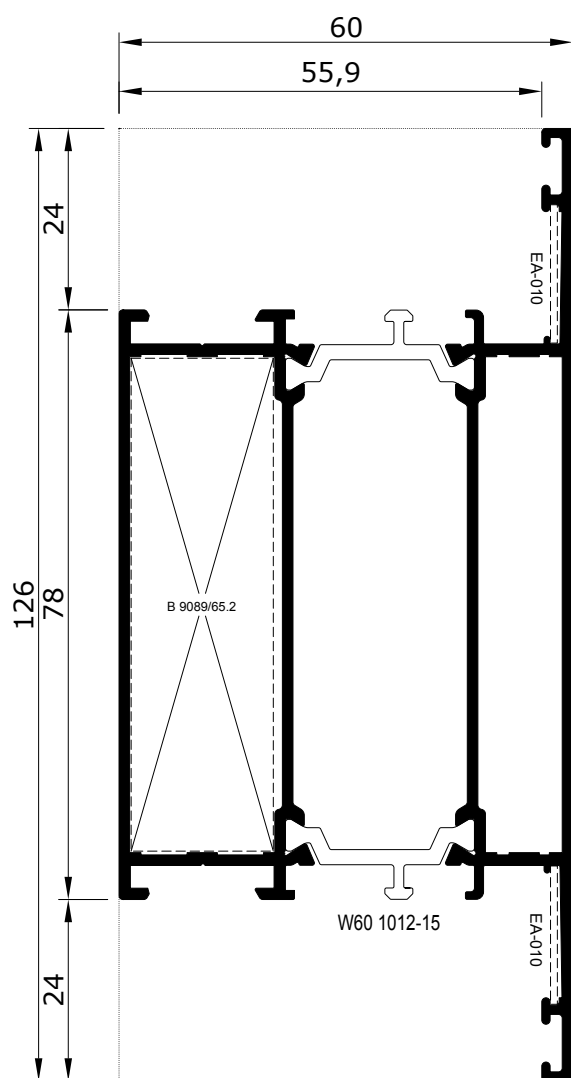

با پروفیل‌های ۱۰۱۷ و ۱۰۱۸ استفاده می‌گردد.

Profile No.	Weight (kg/m)	Static Value
کد پروفیل	وزن پروفیل	Jx (cm ⁴) Jy (cm ⁴)
W60 1014-15	2.984 kg/m	35.96 / 172.78

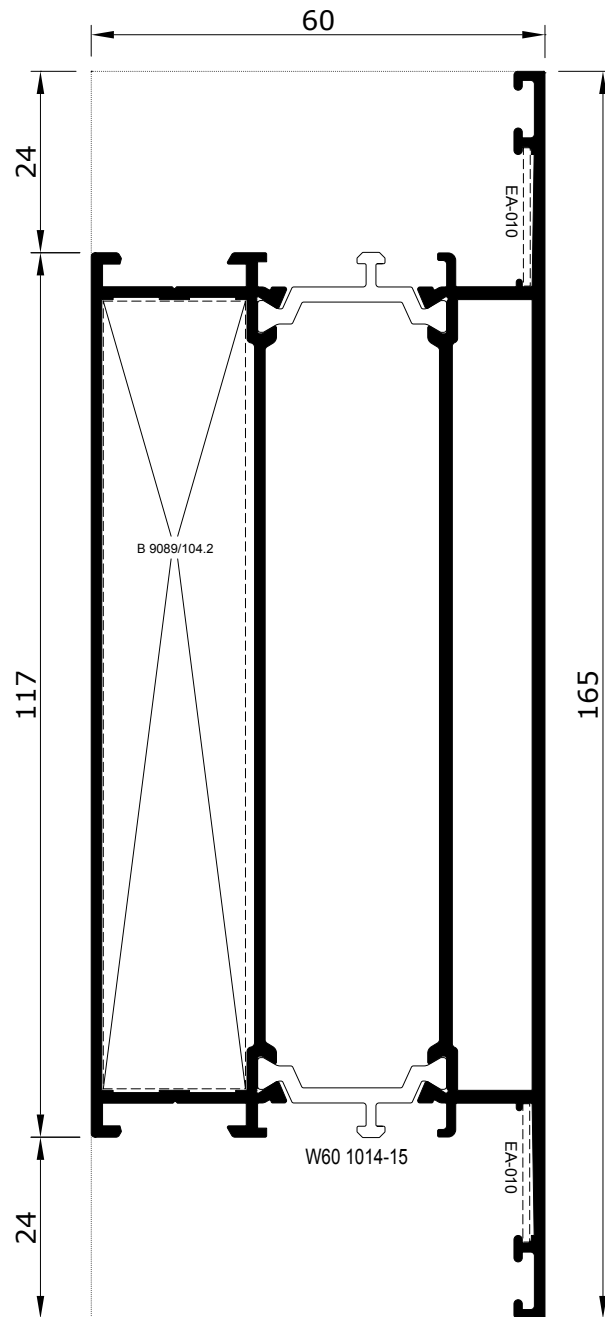

Profile No.	Weight (kg/m)	Static Value
کد پروفیل	وزن پروفیل	Jx (cm ⁴) Jy (cm ⁴)
W60 1015-15	1.303 kg/m	18.87 / 6.69
W60 1016-15	1.521 kg/m	22.85 / 13.58
W60 1017-15	1.939 kg/m	30.29 / 39.78
W60 1018-20	2.239 kg/m	36.19 / 42.82

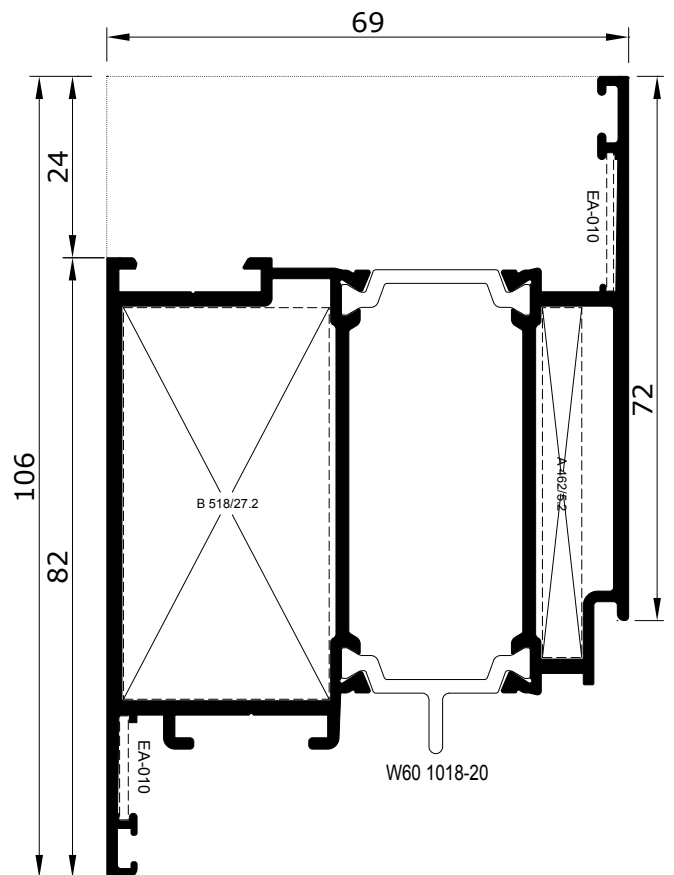
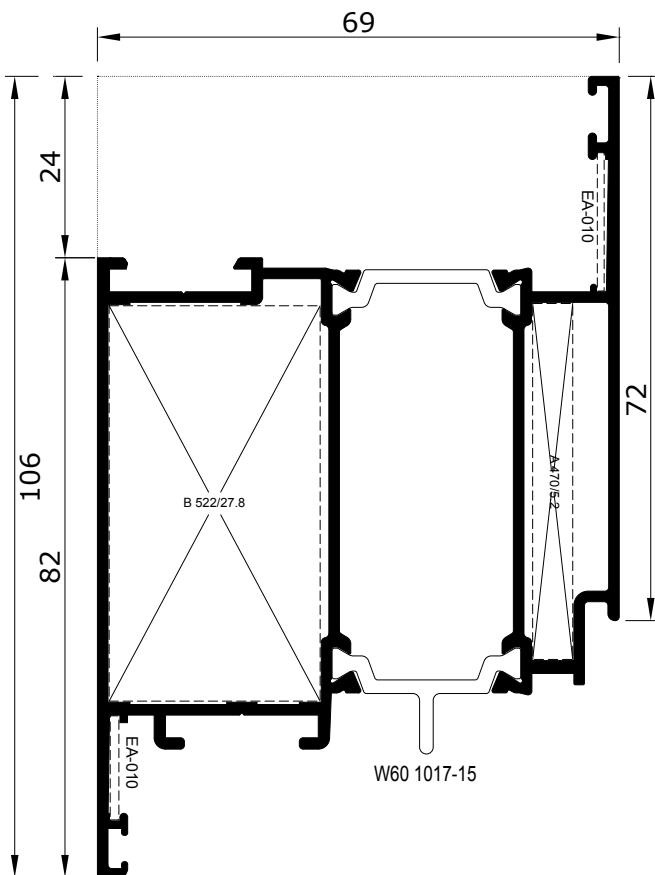
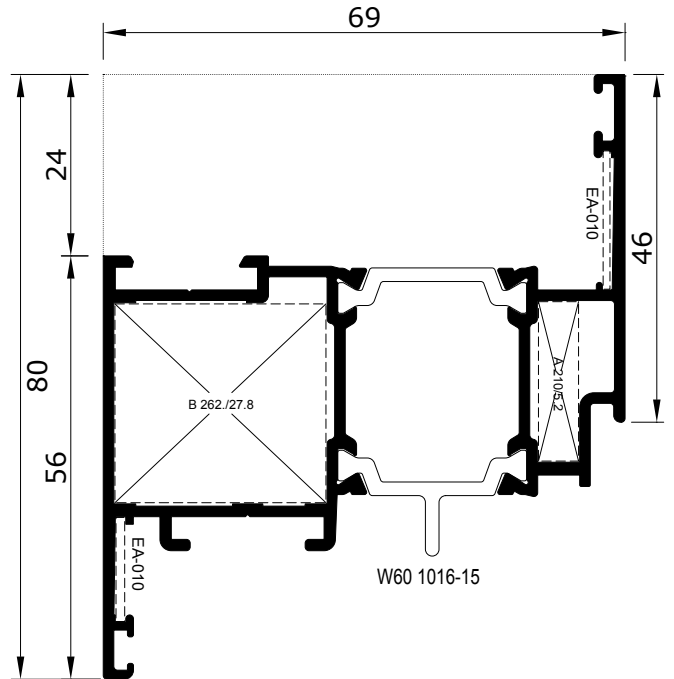
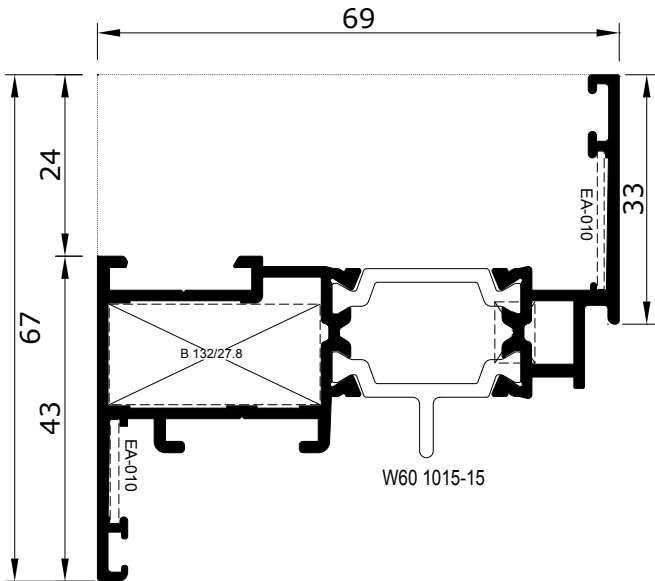

Profile No.	Weight (kg/m)	Static Value
کد پروفیل	وزن پروفیل	Jx (cm ⁴) Jy (cm ⁴)
W60 1019-15	1.310 kg/m	14.29 / 13.80
W60 1020-15	1.415 kg/m	26.84 / 15.09
W60 1021-15	1.556 kg/m	16.89 / 30.08

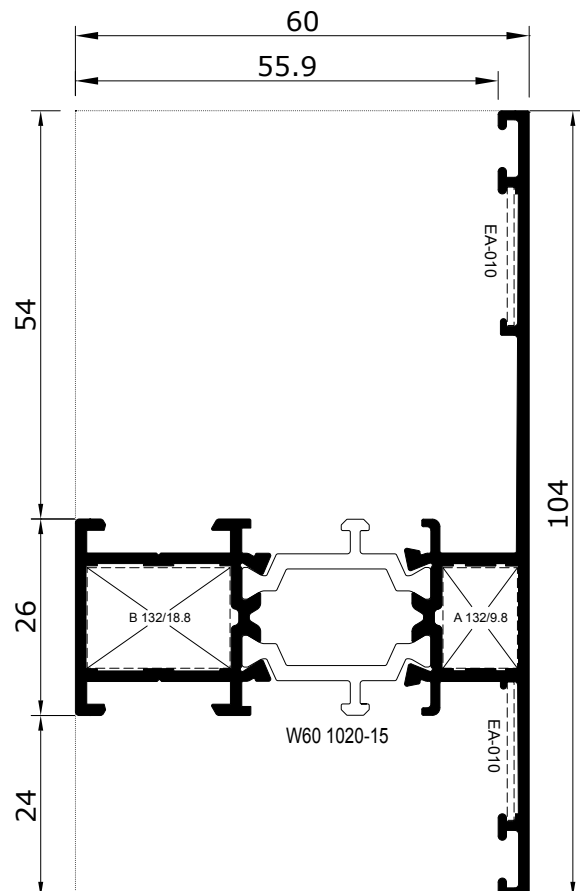
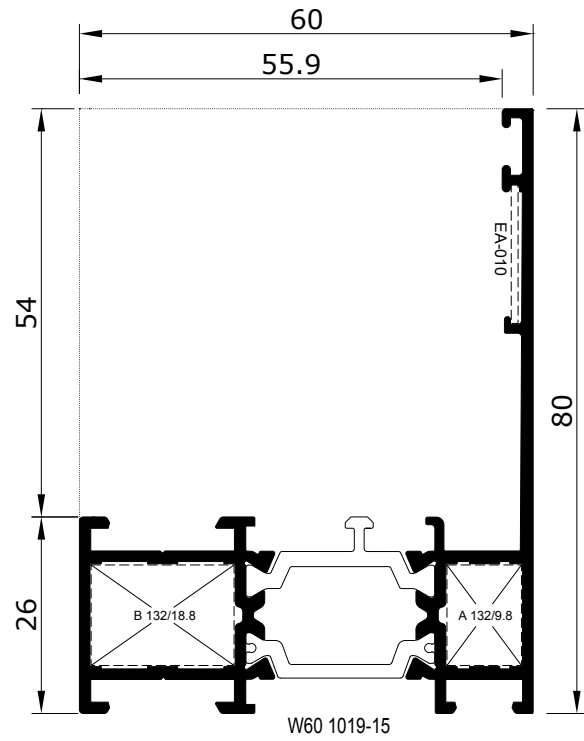
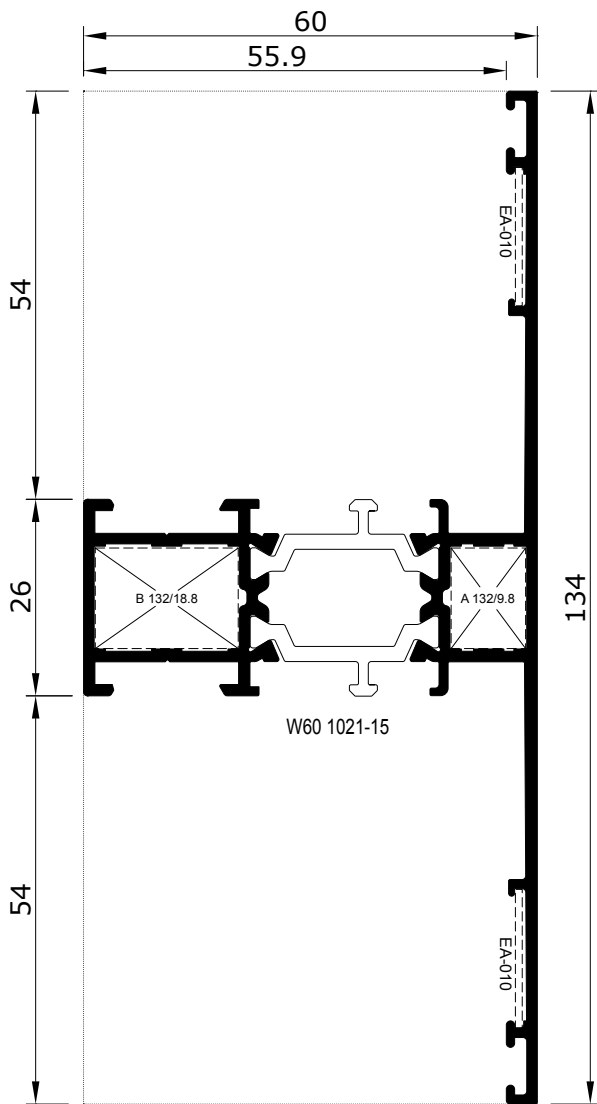

Profile No.	Weight (kg/m)	Static Value
کد پروفیل	وزن پروفیل	Jx (cm ⁴) Jy (cm ⁴)
W60 1022-15	1.380 kg/m	16.10 / 9.85
W60 1023-15	1.100 kg/m	
W60 1024-15	1.720 kg/m	31.63 / 20.50
1034	0.130 kg/m	
1035	0.935 kg/m	

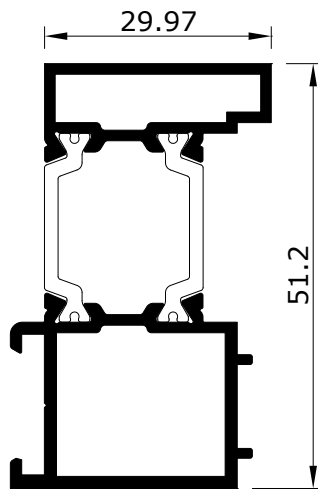

آداپتور فریم لنگه مخفی

W60 1023-15

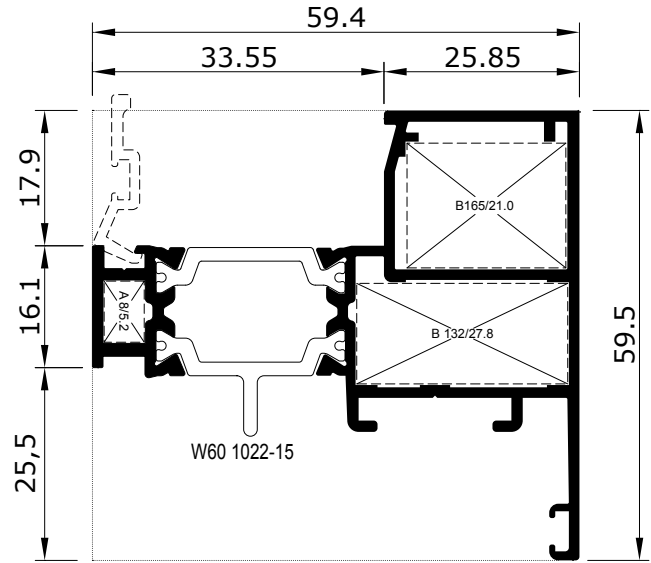

پروفیل بازشو در سیستم مخفی

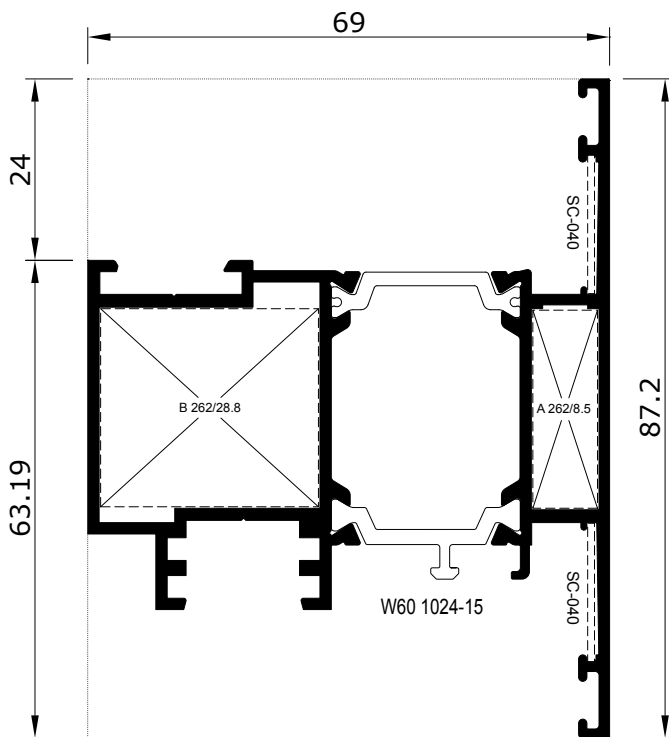

پروفیل بازشو در سیستم لولا محوری

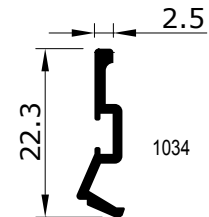

زهوار سیستم لنگه مخفی

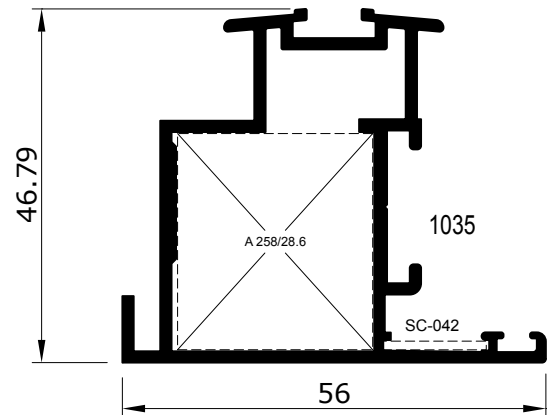

آداپتور لولا محوری

Profile No.	Weight (kg/m)	Static Value
کد پروفیل	وزن پروفیل	Jx (cm ⁴) Jy (cm ⁴)
W60 1027-15	1.291 kg/m	13.72 / 6.71
W60 1028-15	1.830 kg/m	24.37 / 32.48
W60 1029-15	1.290 kg/m	
W60 1030-15	1.345 kg/m	
1045	0.130 kg/m	

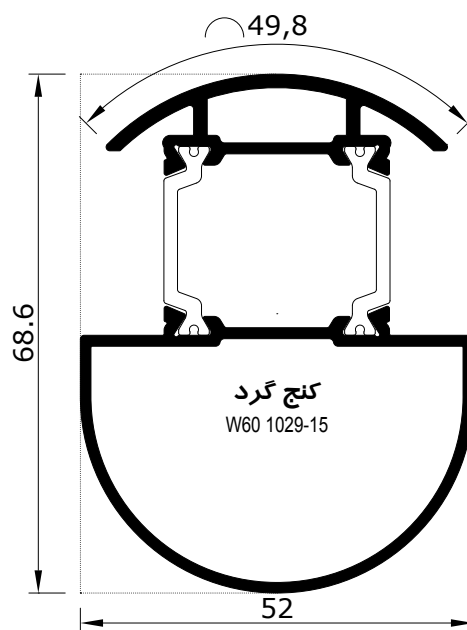
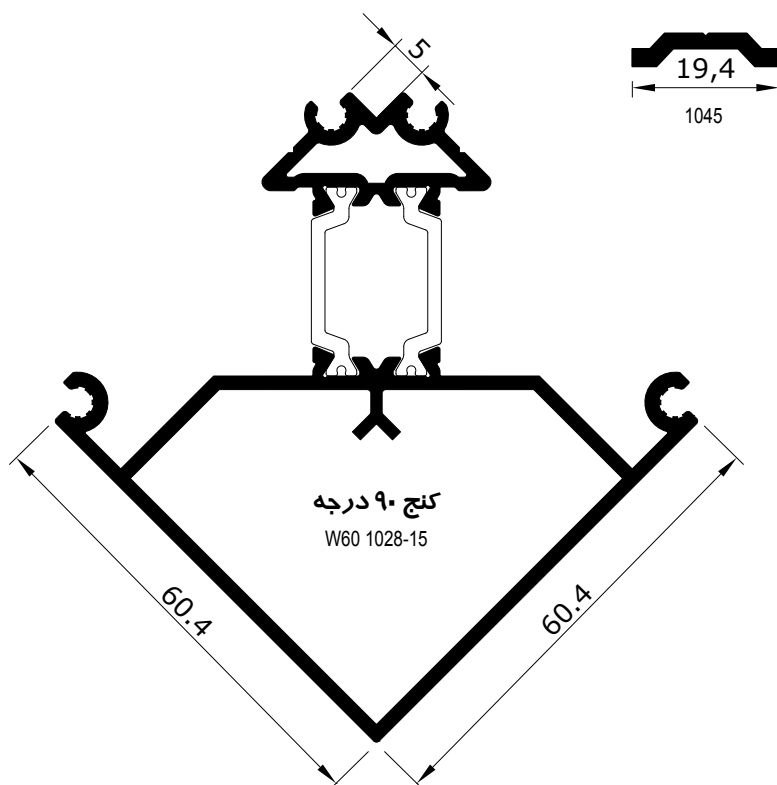
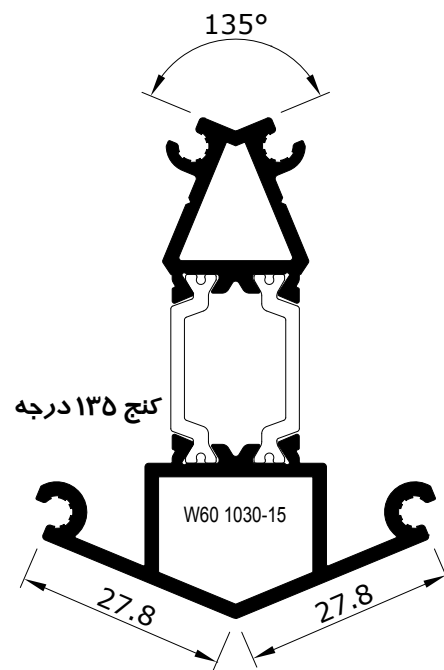
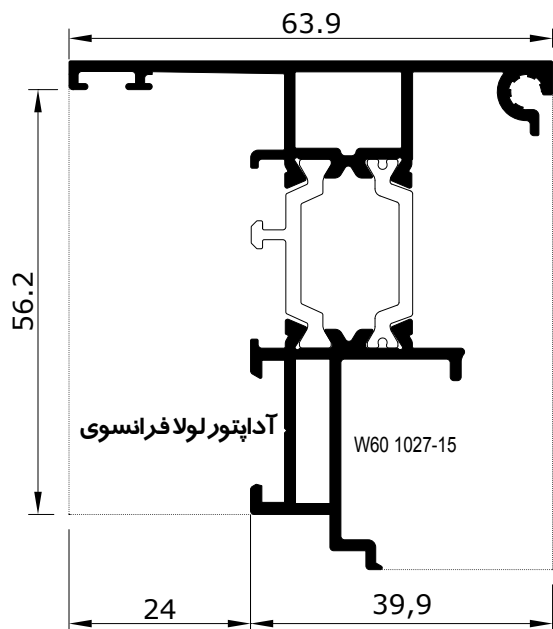

Profile No.	Weight (kg/m)
کد پروفیل	وزن پروفیل
1036	0.385 kg/m
1037	0.370 kg/m
1038	0.360 kg/m

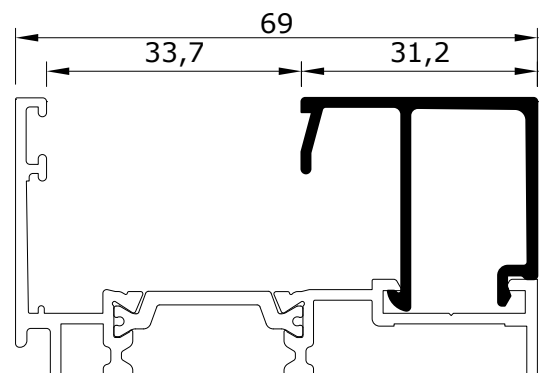
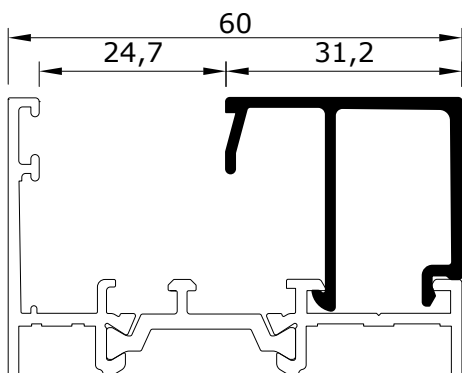
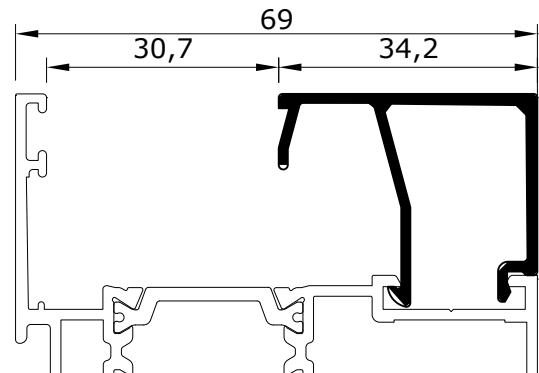
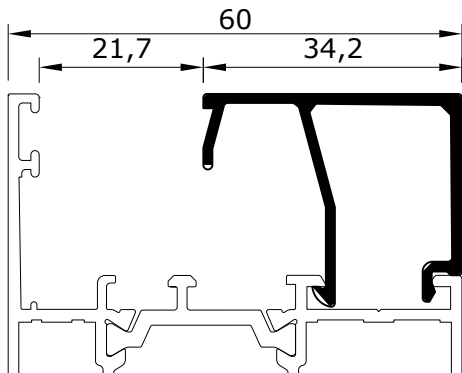
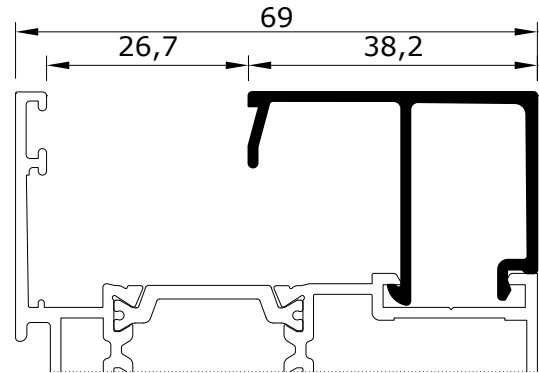

Profile No.	Weight (kg/m)
کد پروفیل	وزن پروفیل
1039	0.340 kg/m
1040	0.305 kg/m
1041	0.300 kg/m

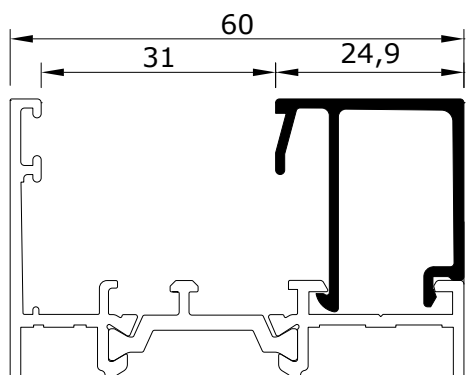

1039

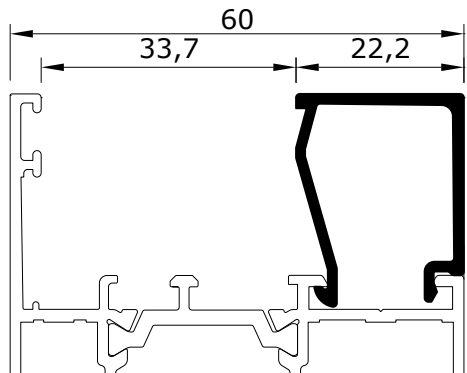
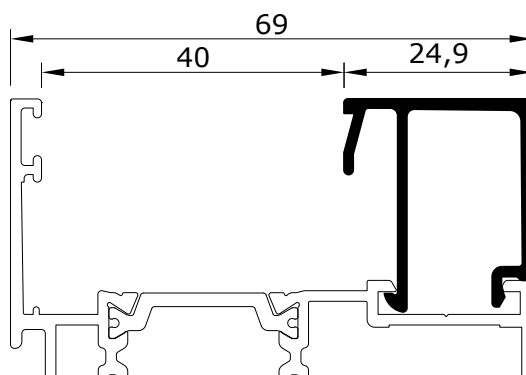

1040

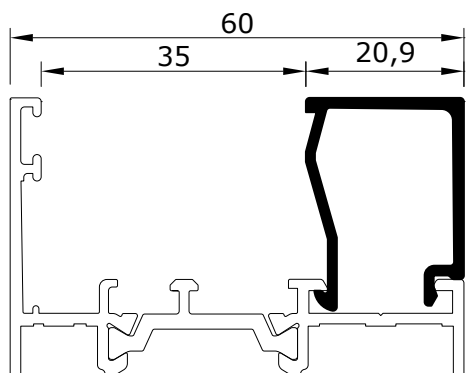
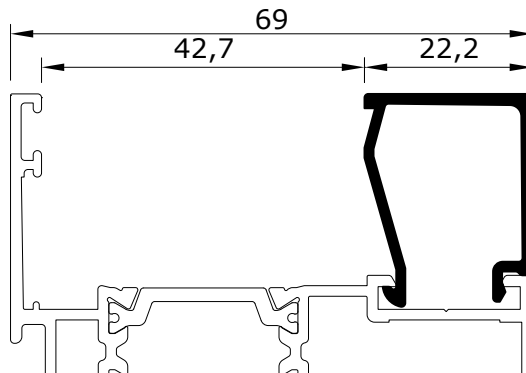

1041

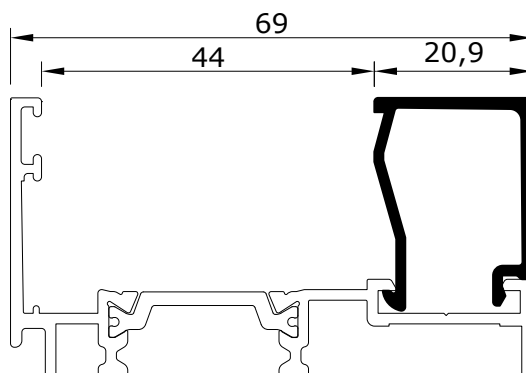

Profile No.	Weight (kg/m)
کد پروفیل	وزن پروفیل
1042	0.280 kg/m
1043	0.270 kg/m
1044	0.250 kg/m

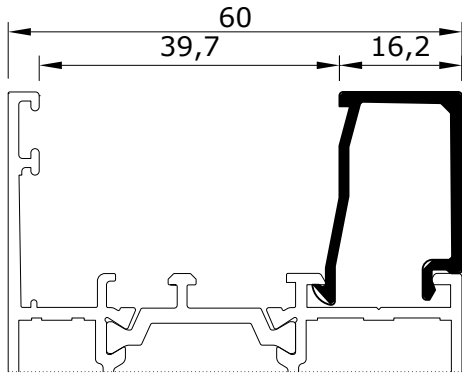

1042

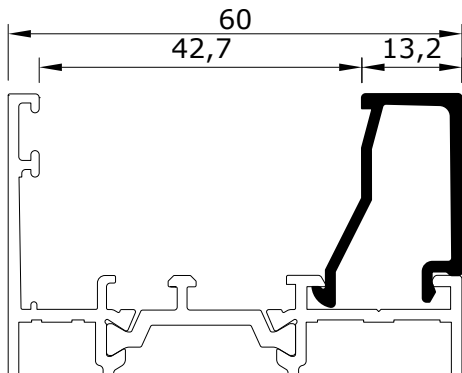
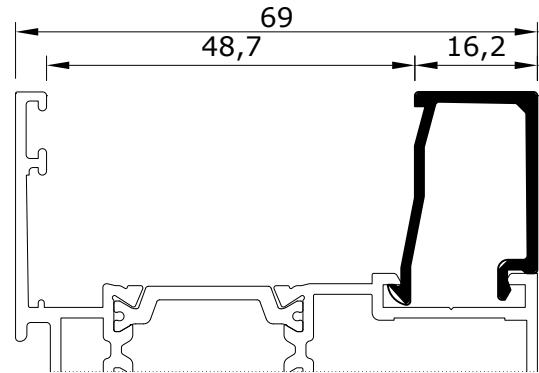

1043

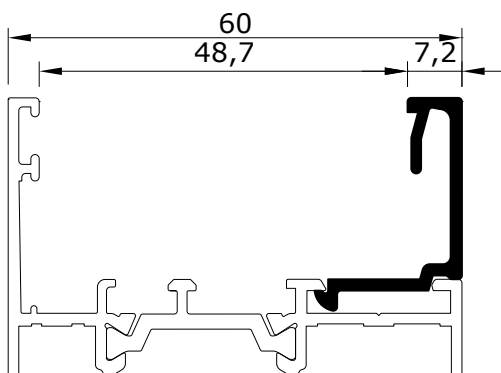
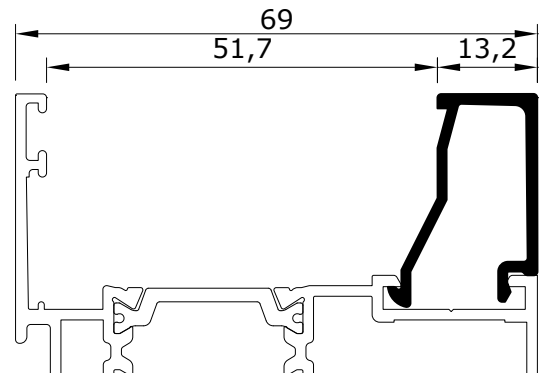

1044

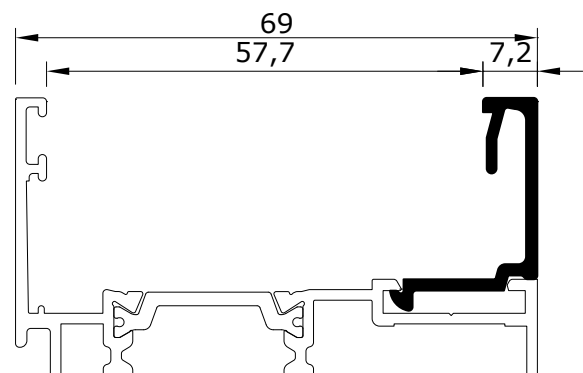

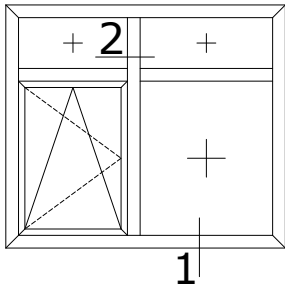

1

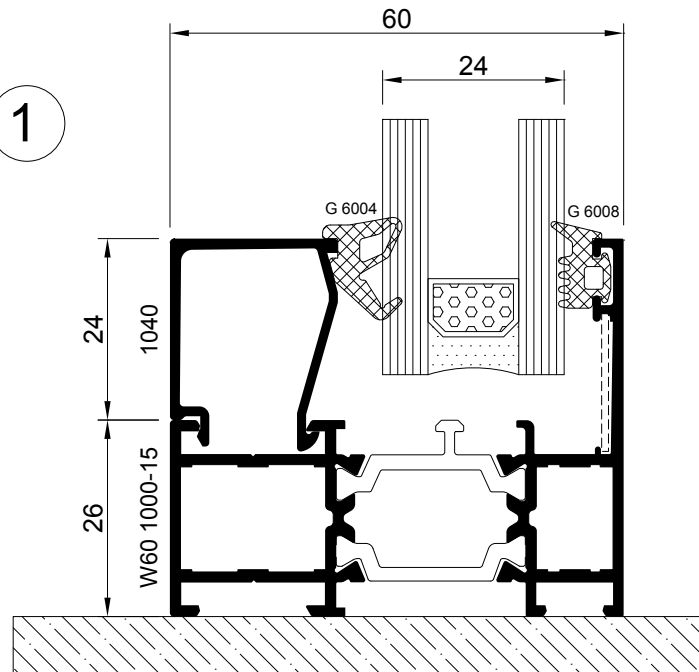

2

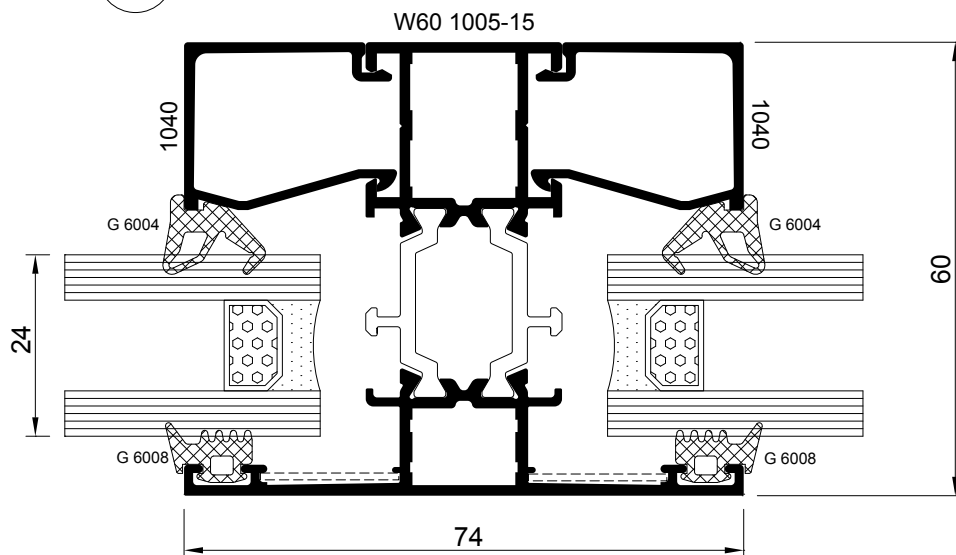

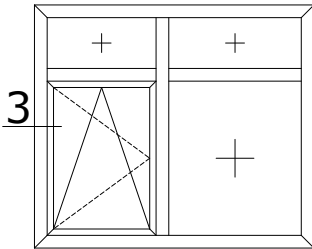

3

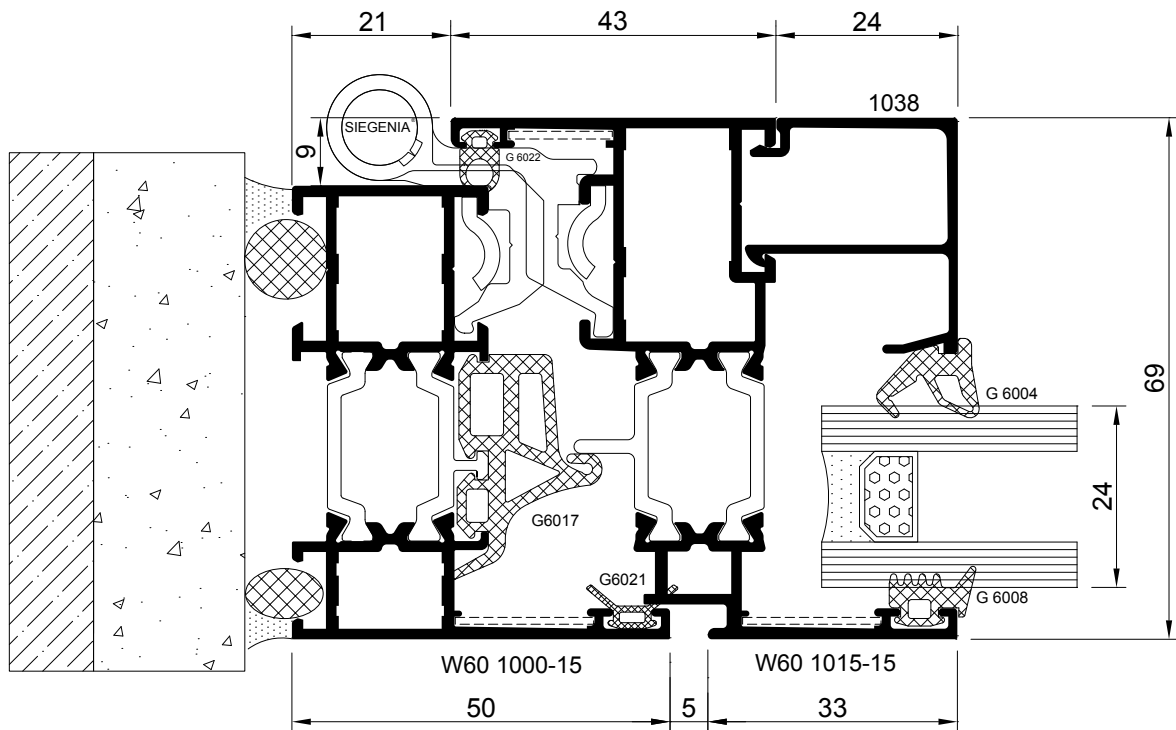

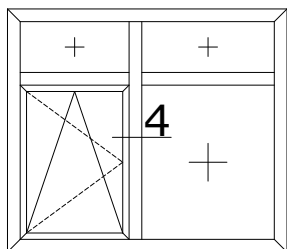

4

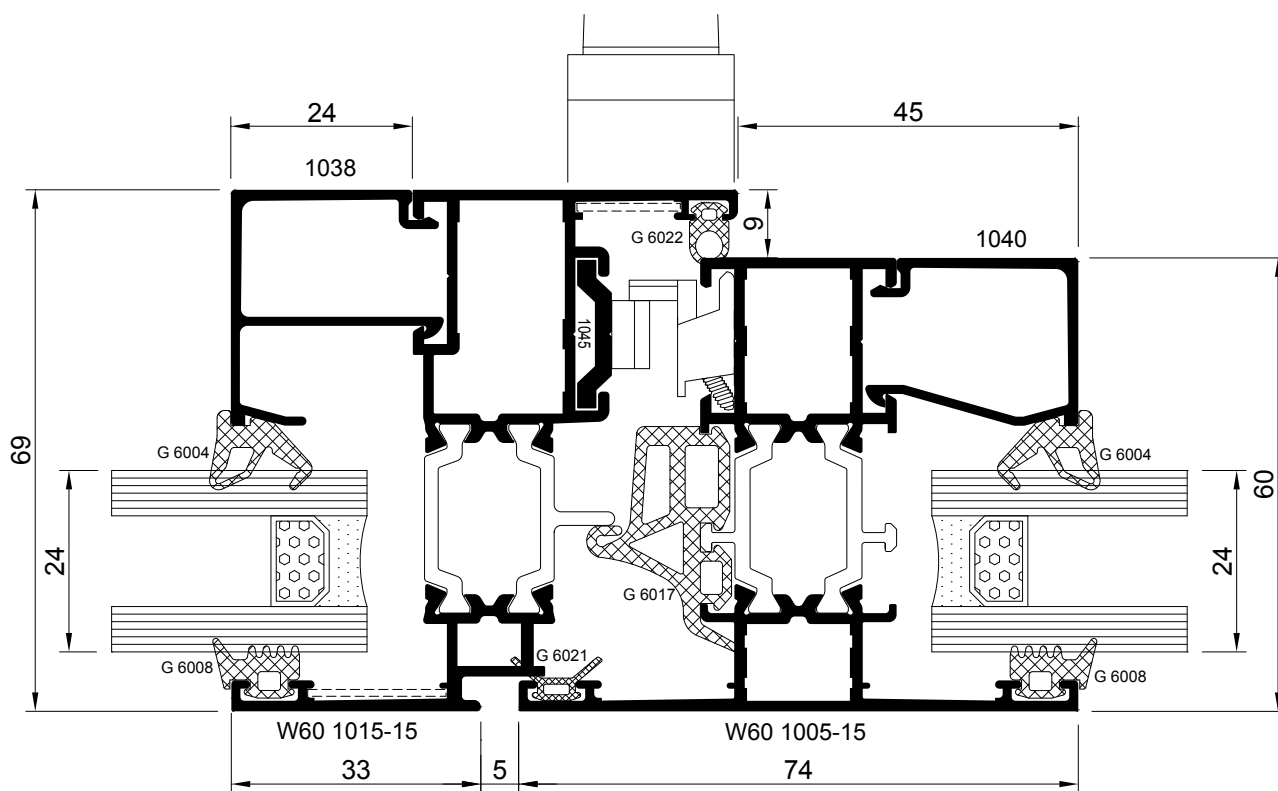

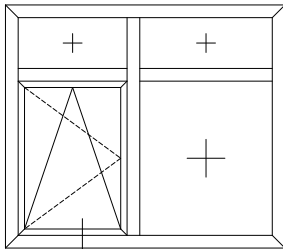

5

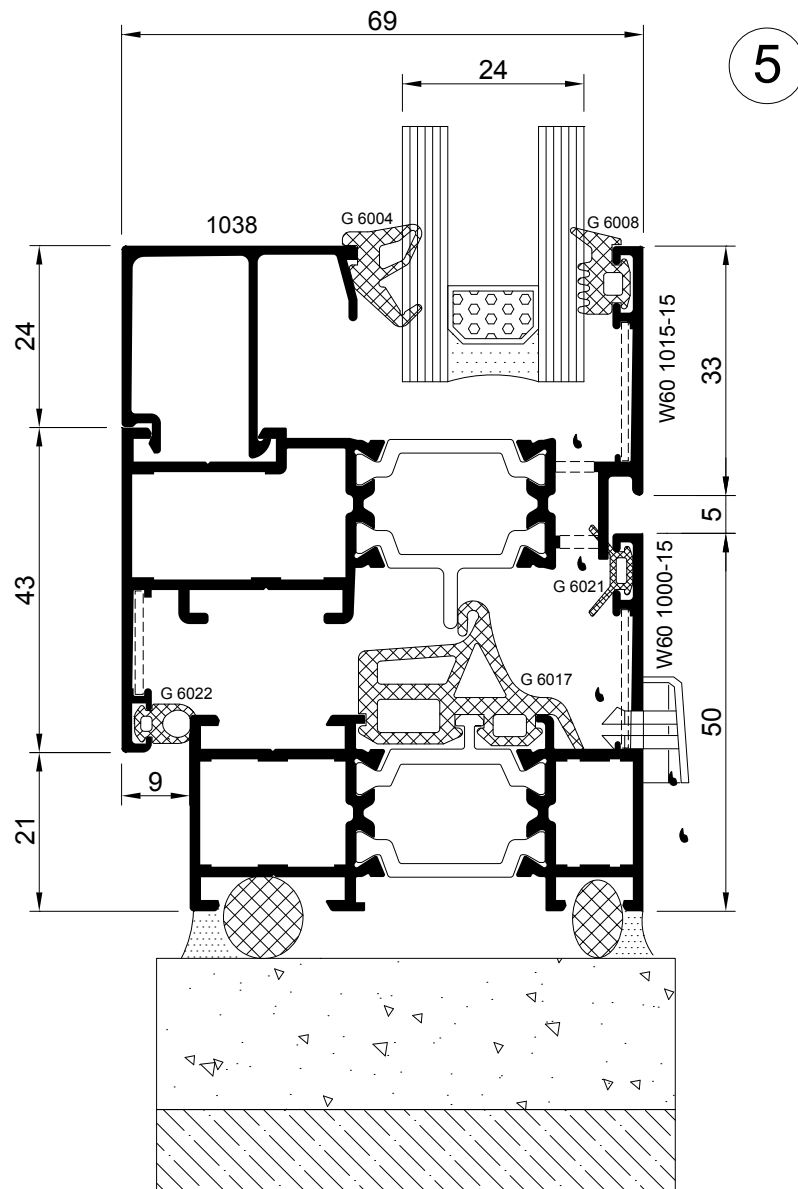

5

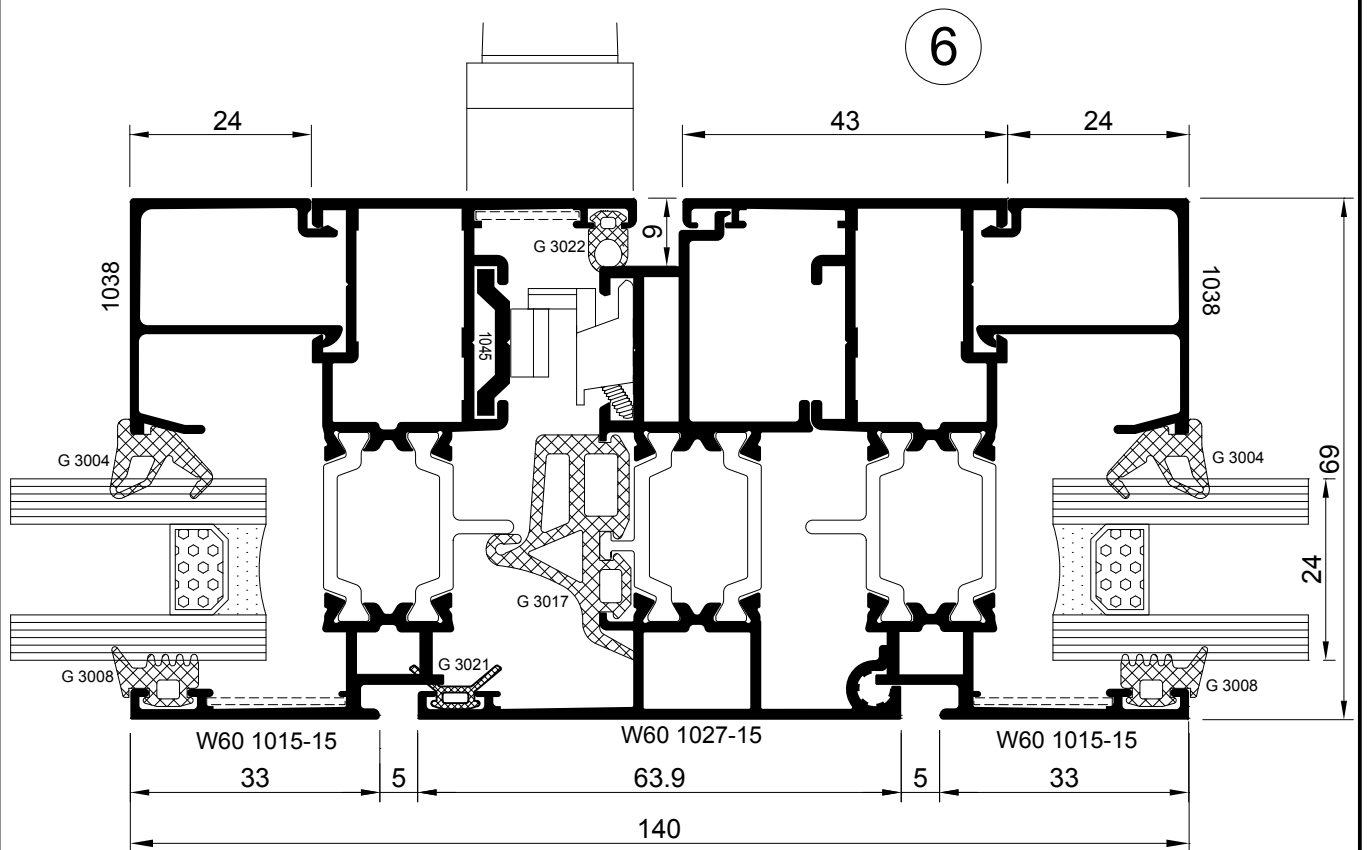
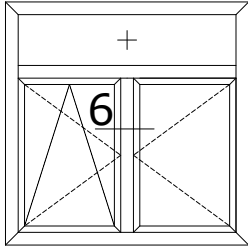

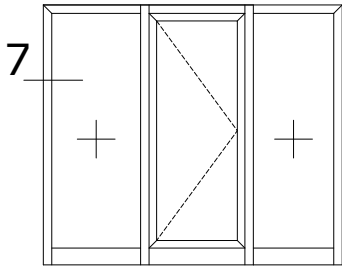

7

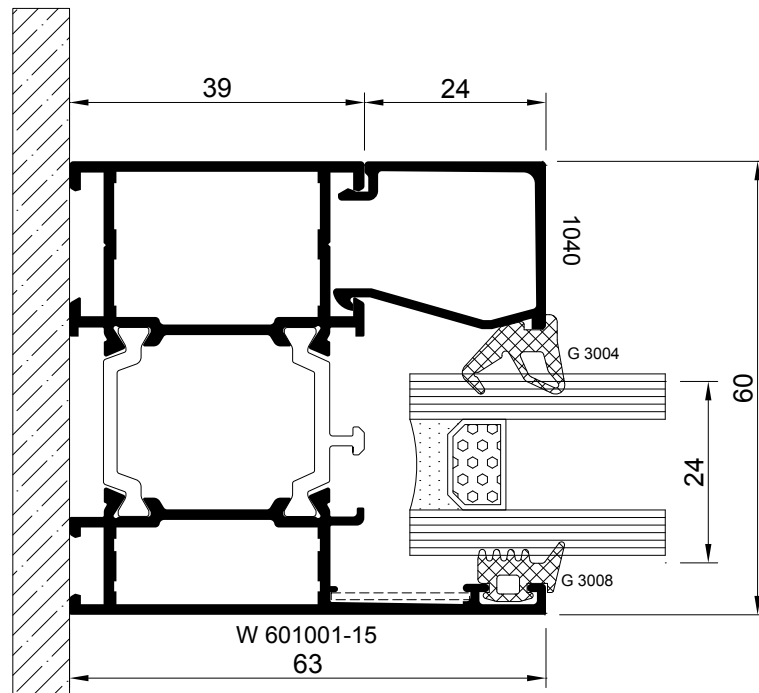

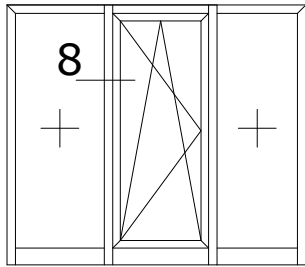

8

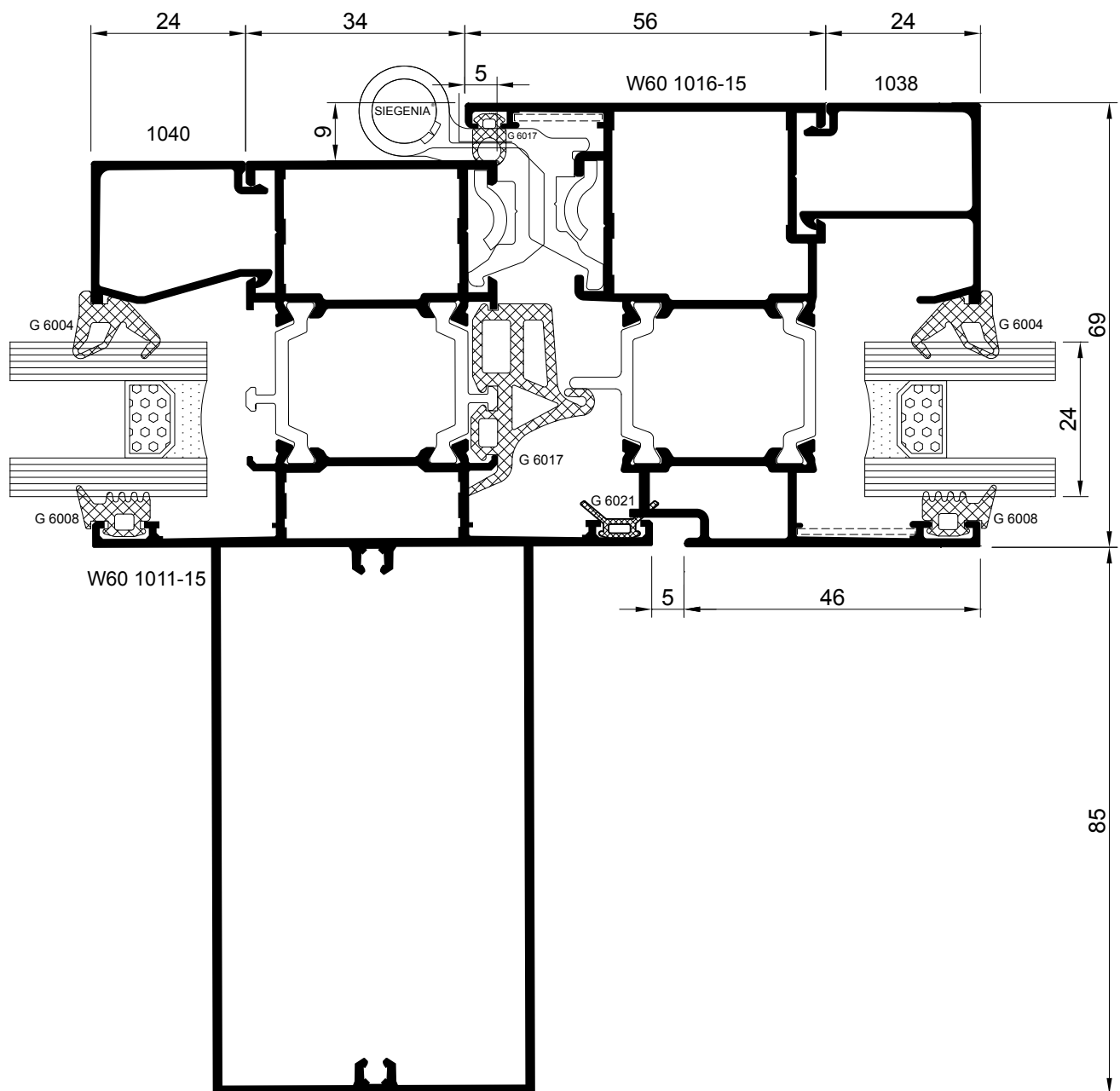

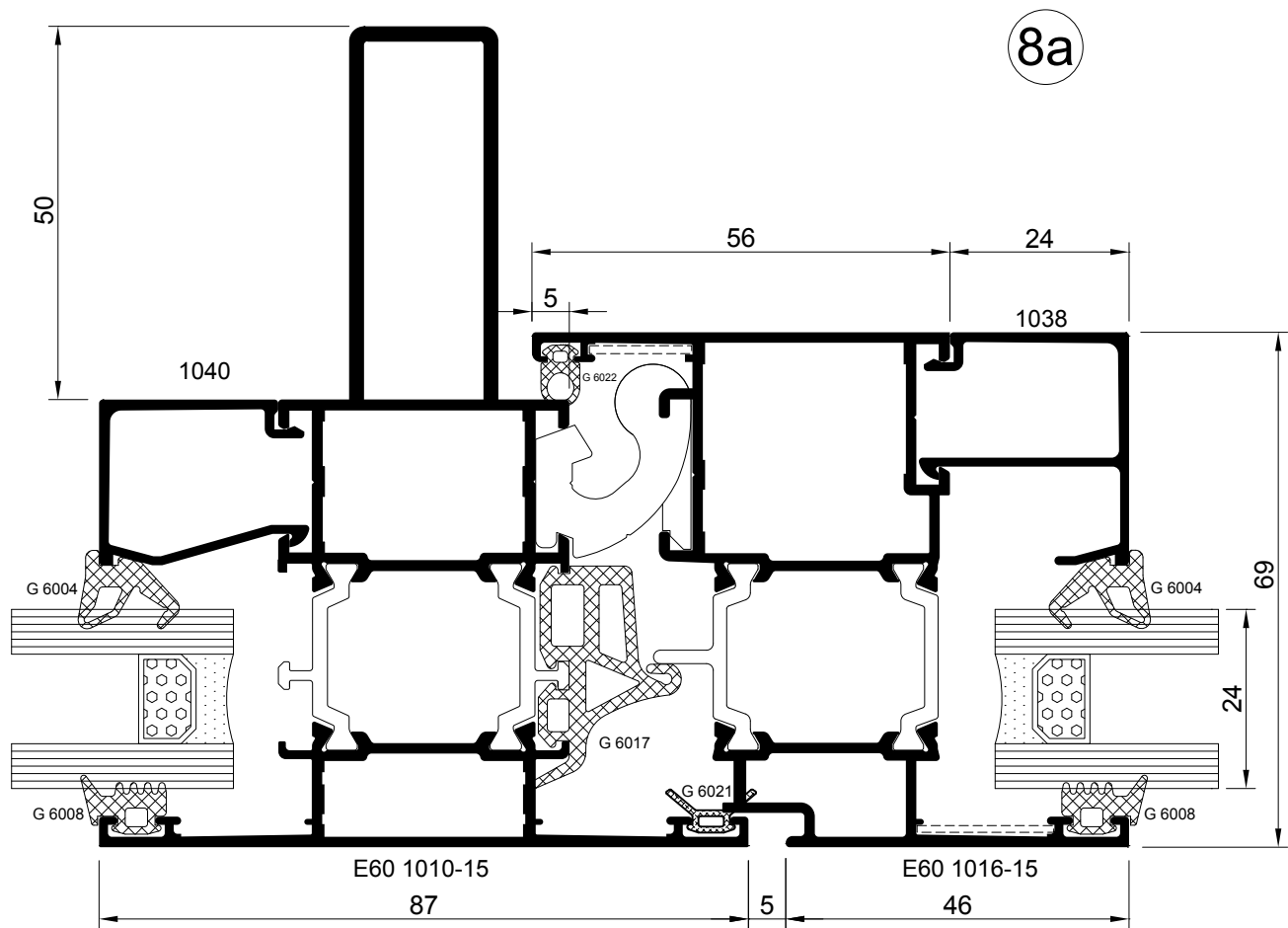
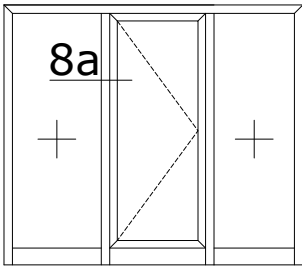

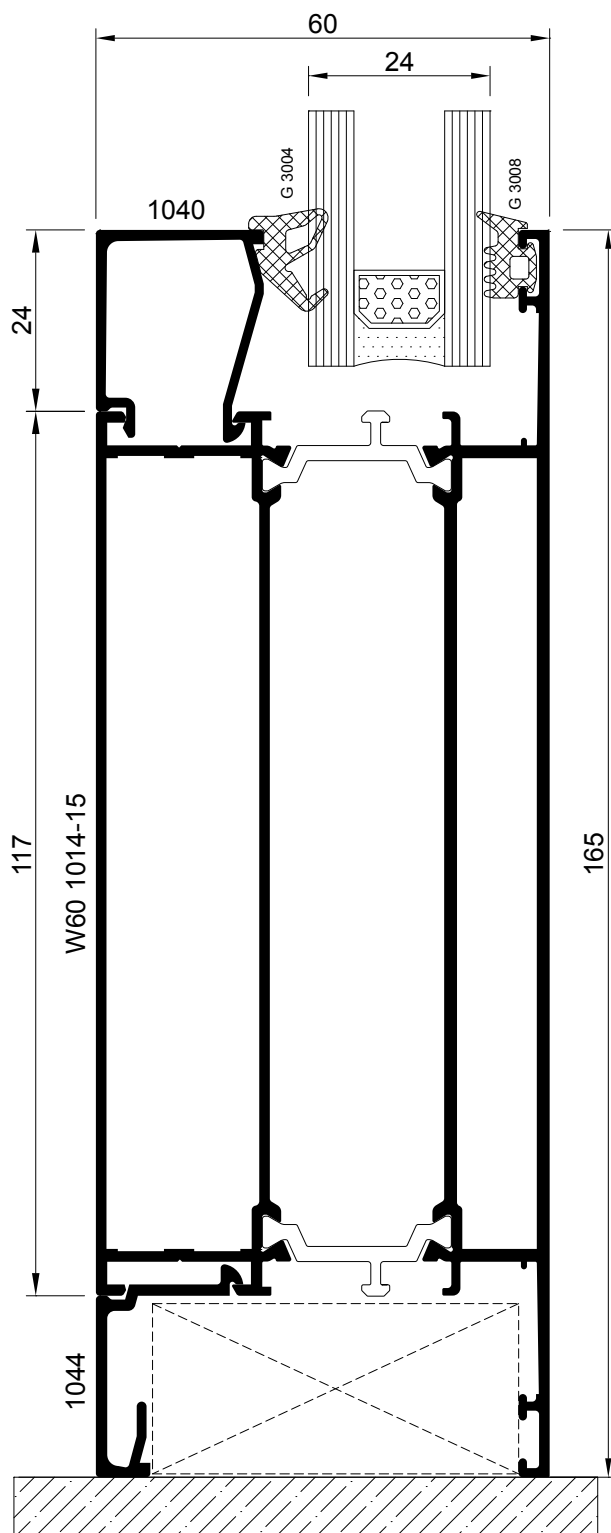
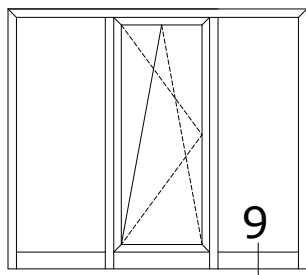

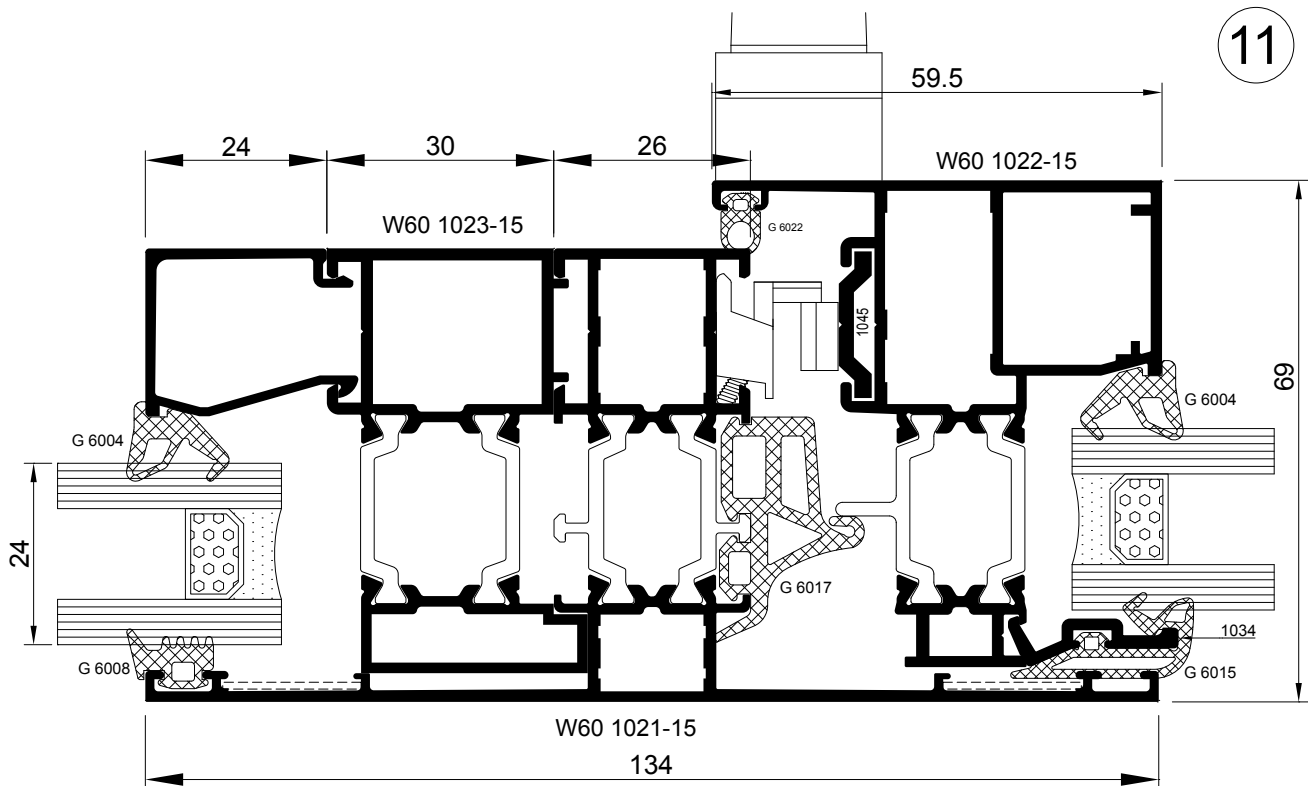
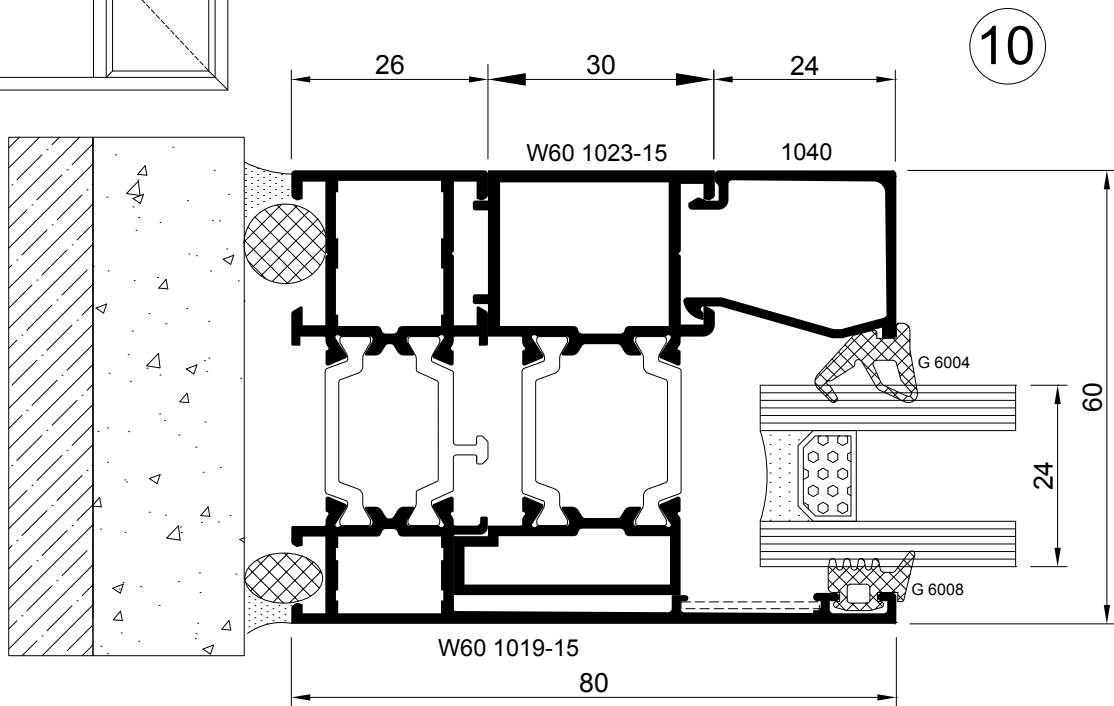
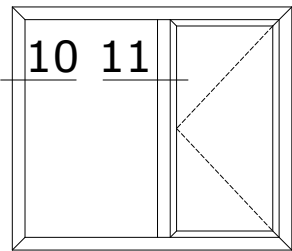

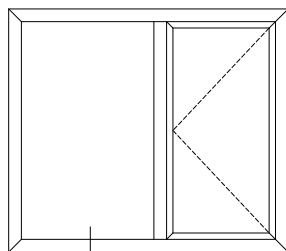

12

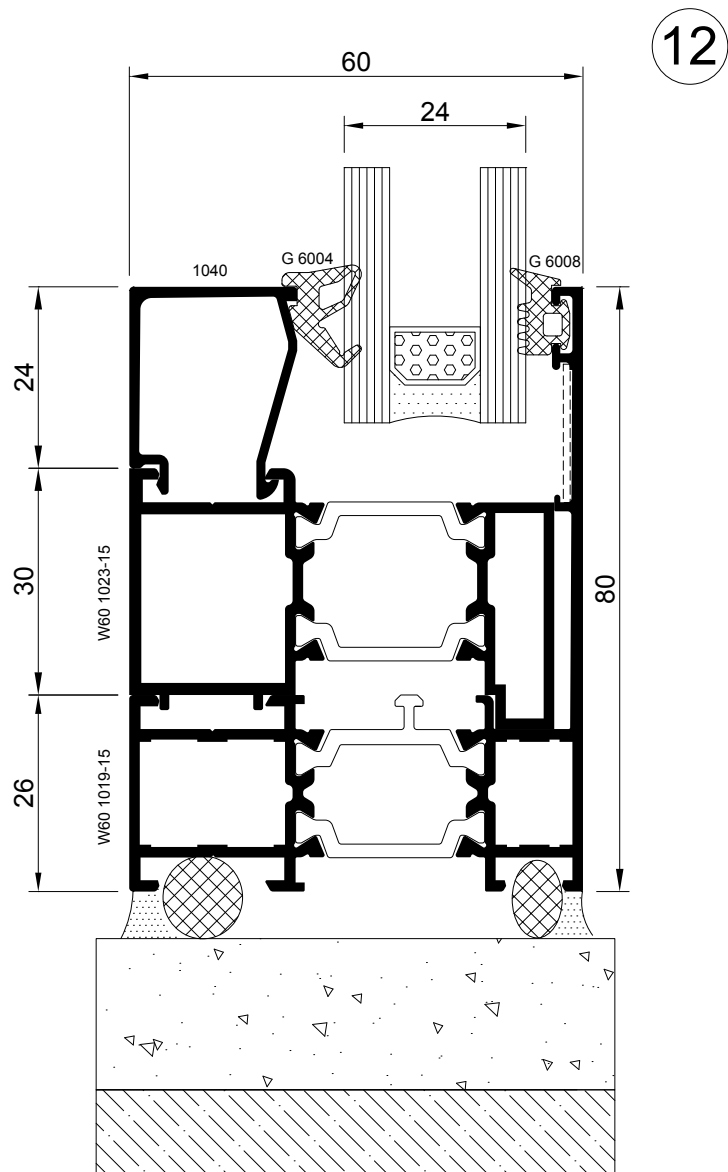

12

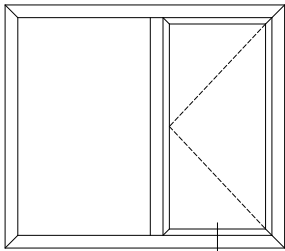

13

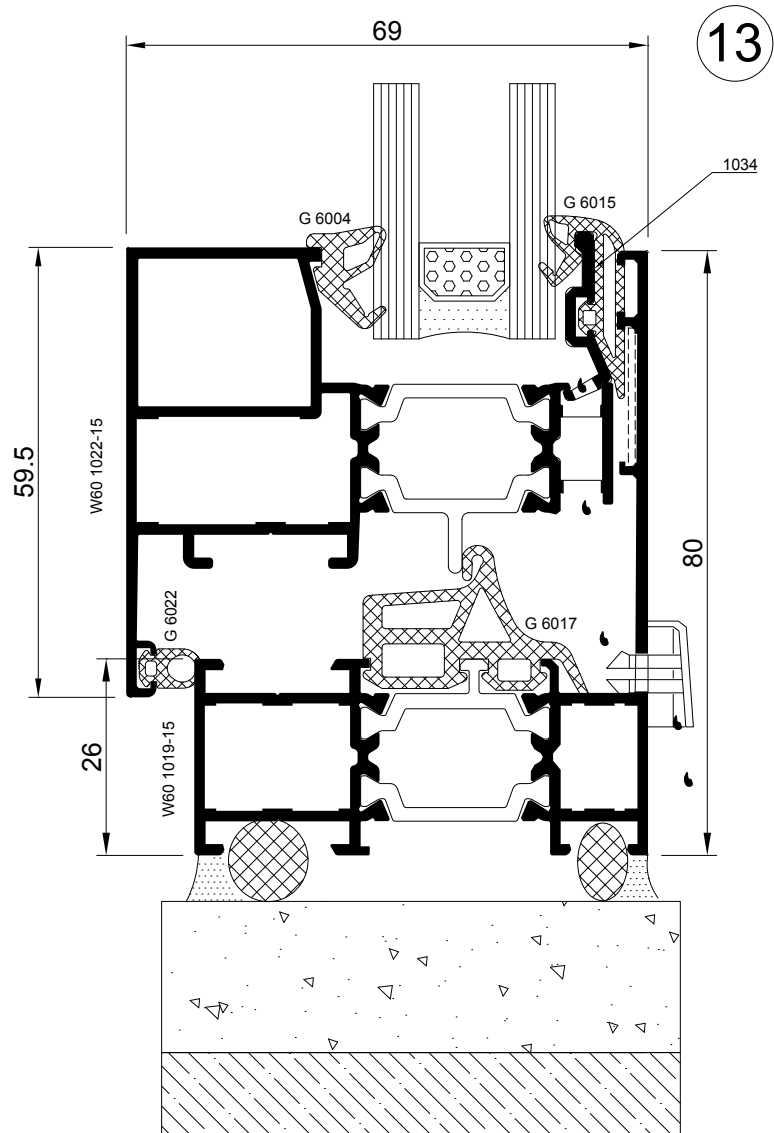

13

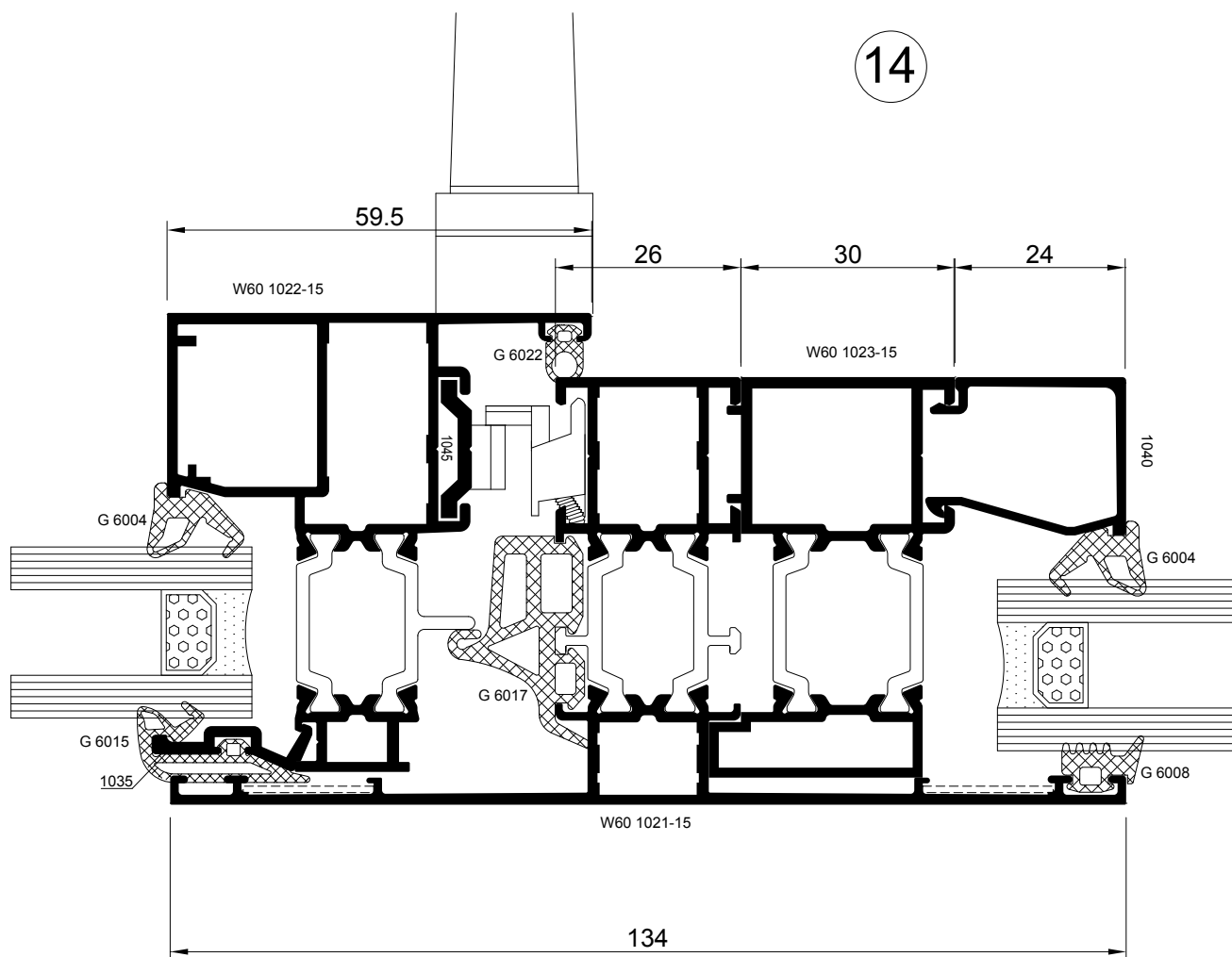
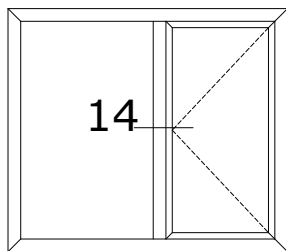

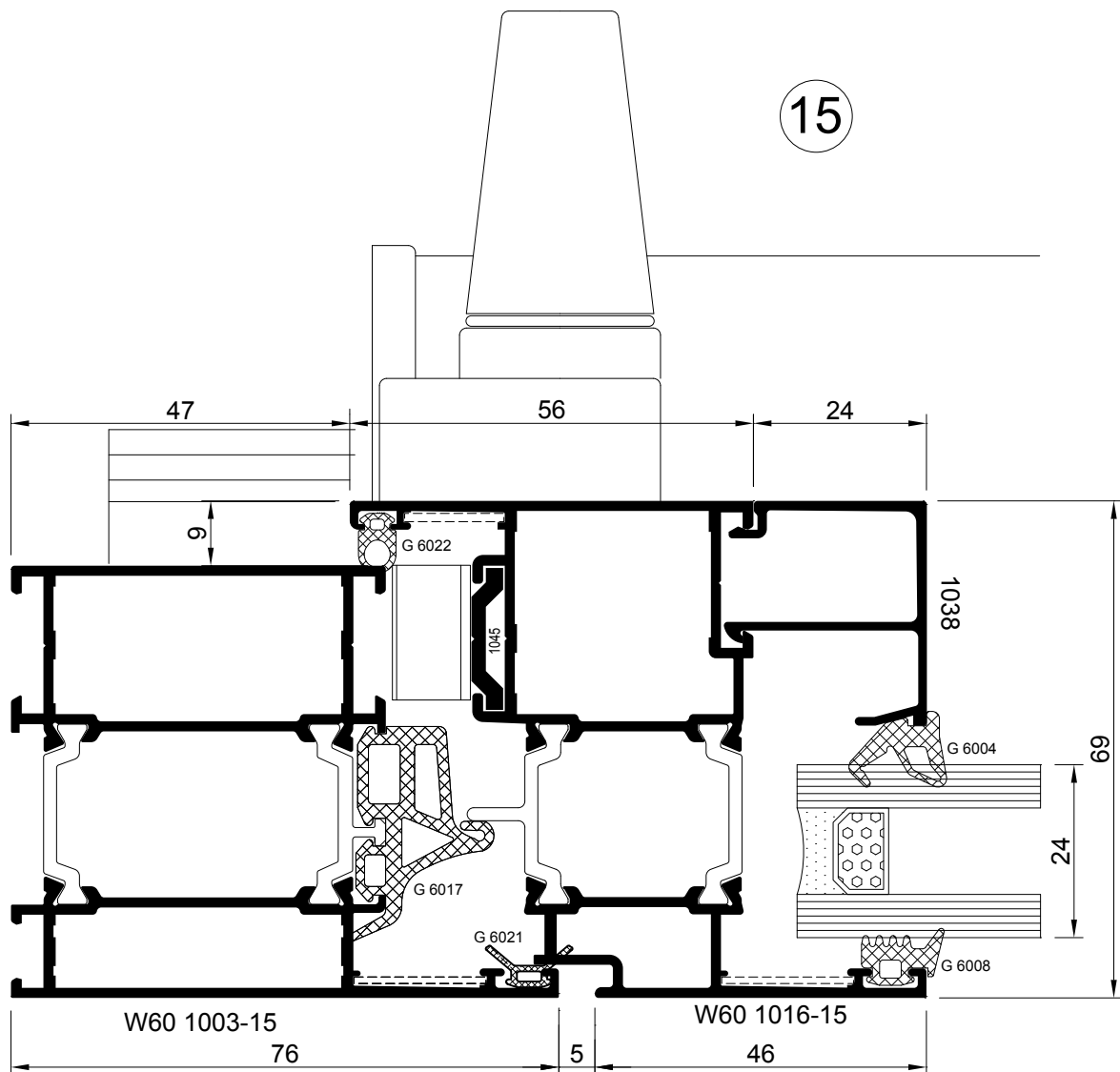
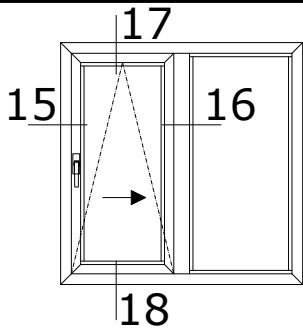

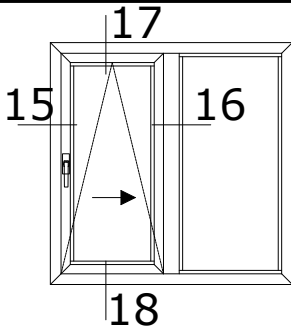

ریل سیستم بازشو فولکس واگنی

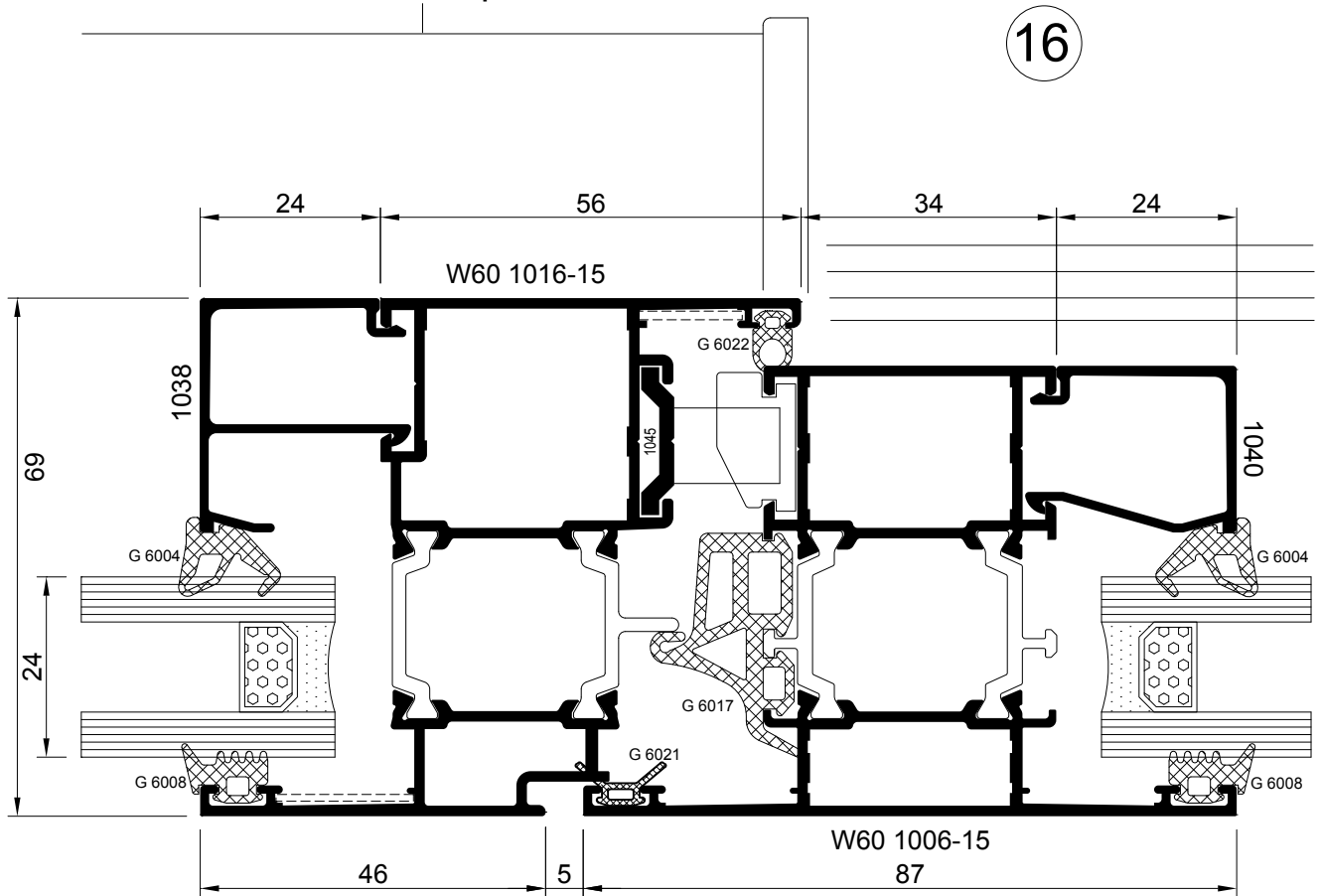

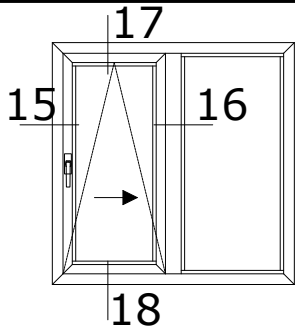

17

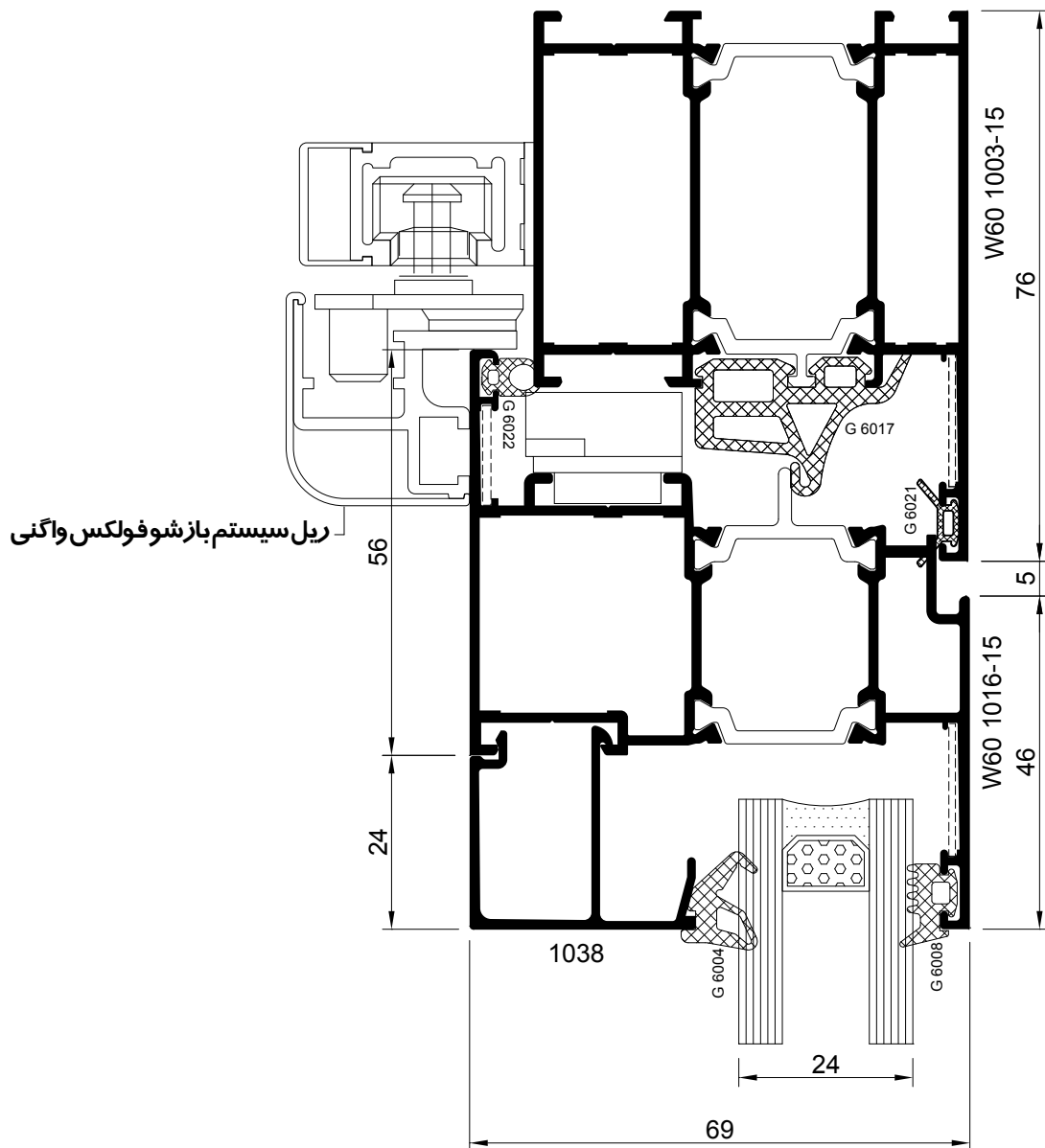

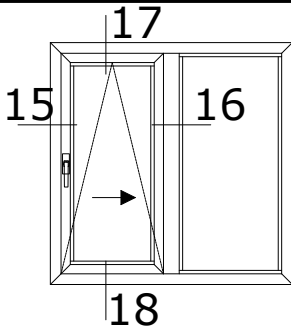

18

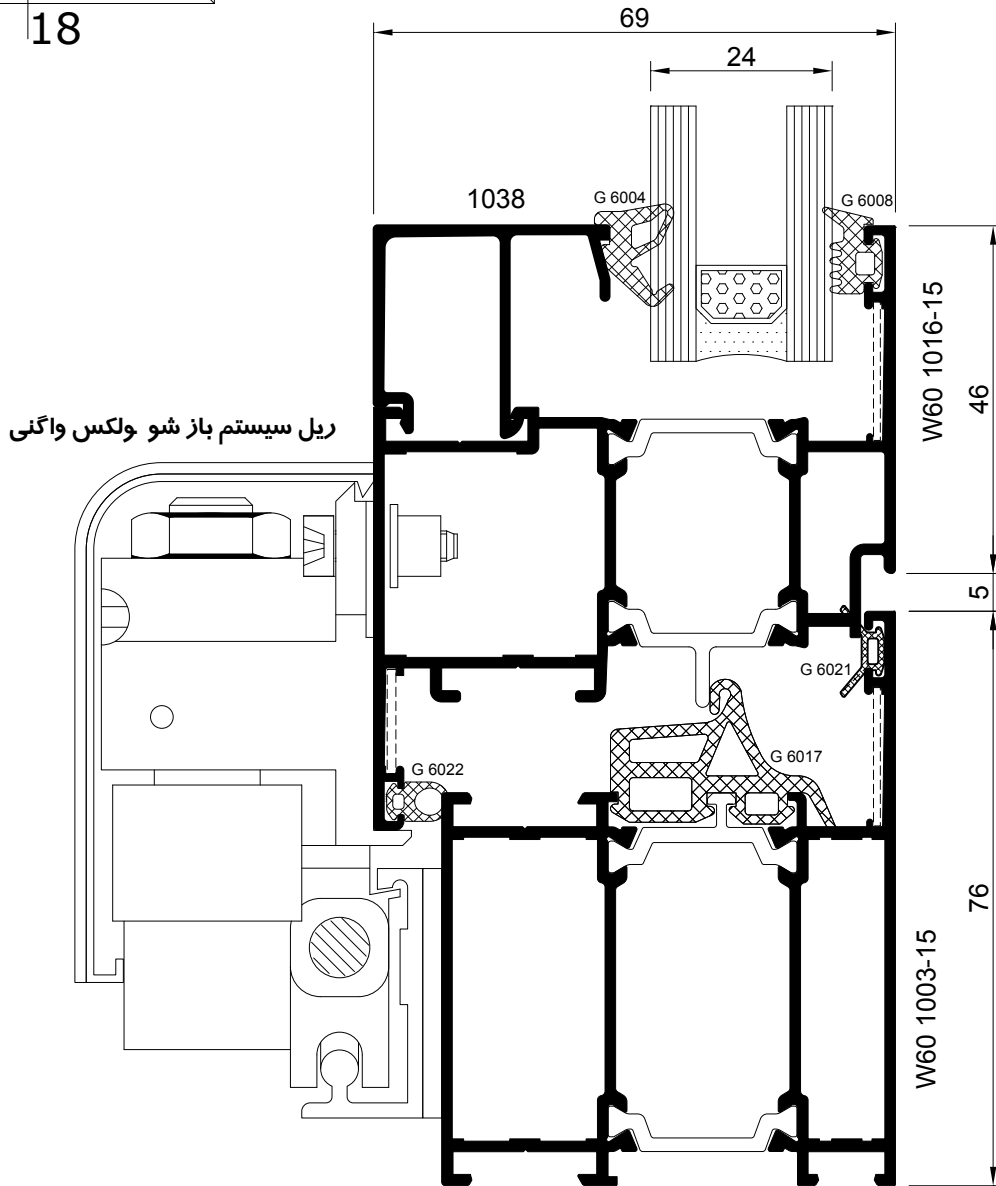

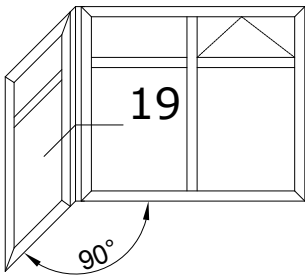

19

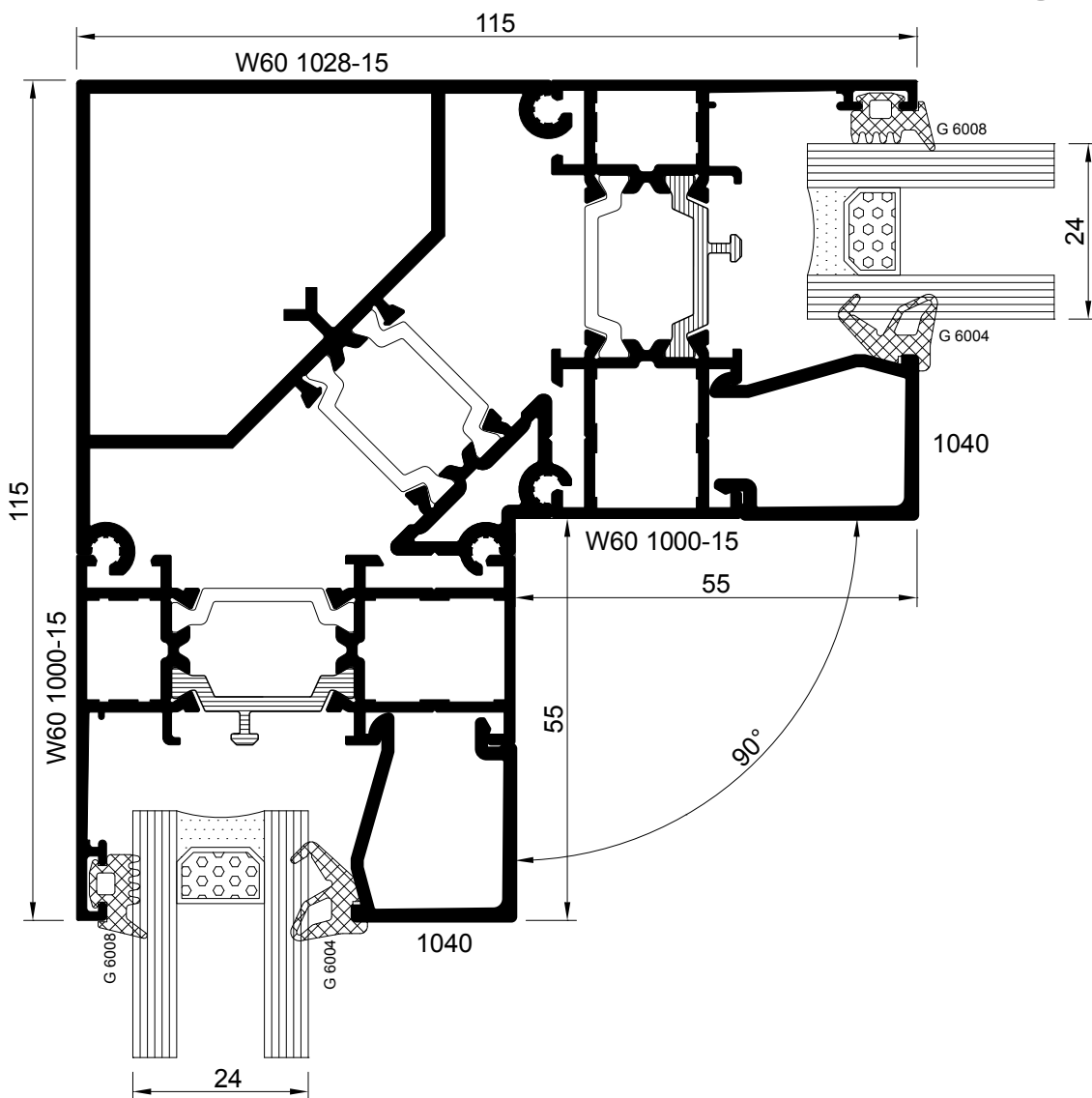

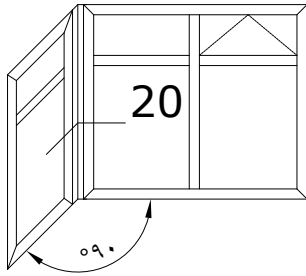

20

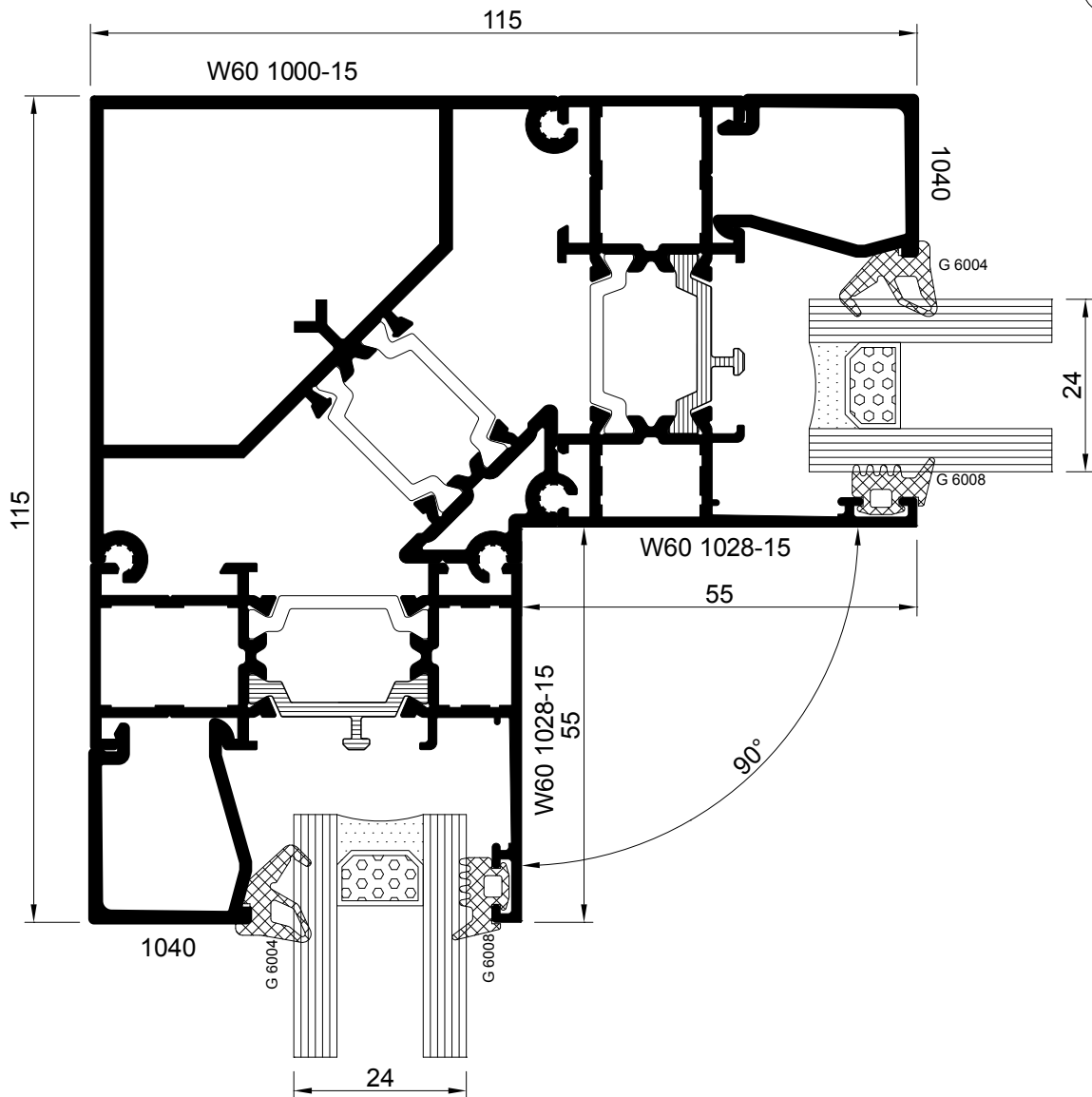

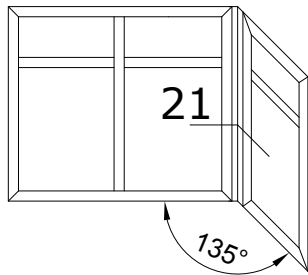

21

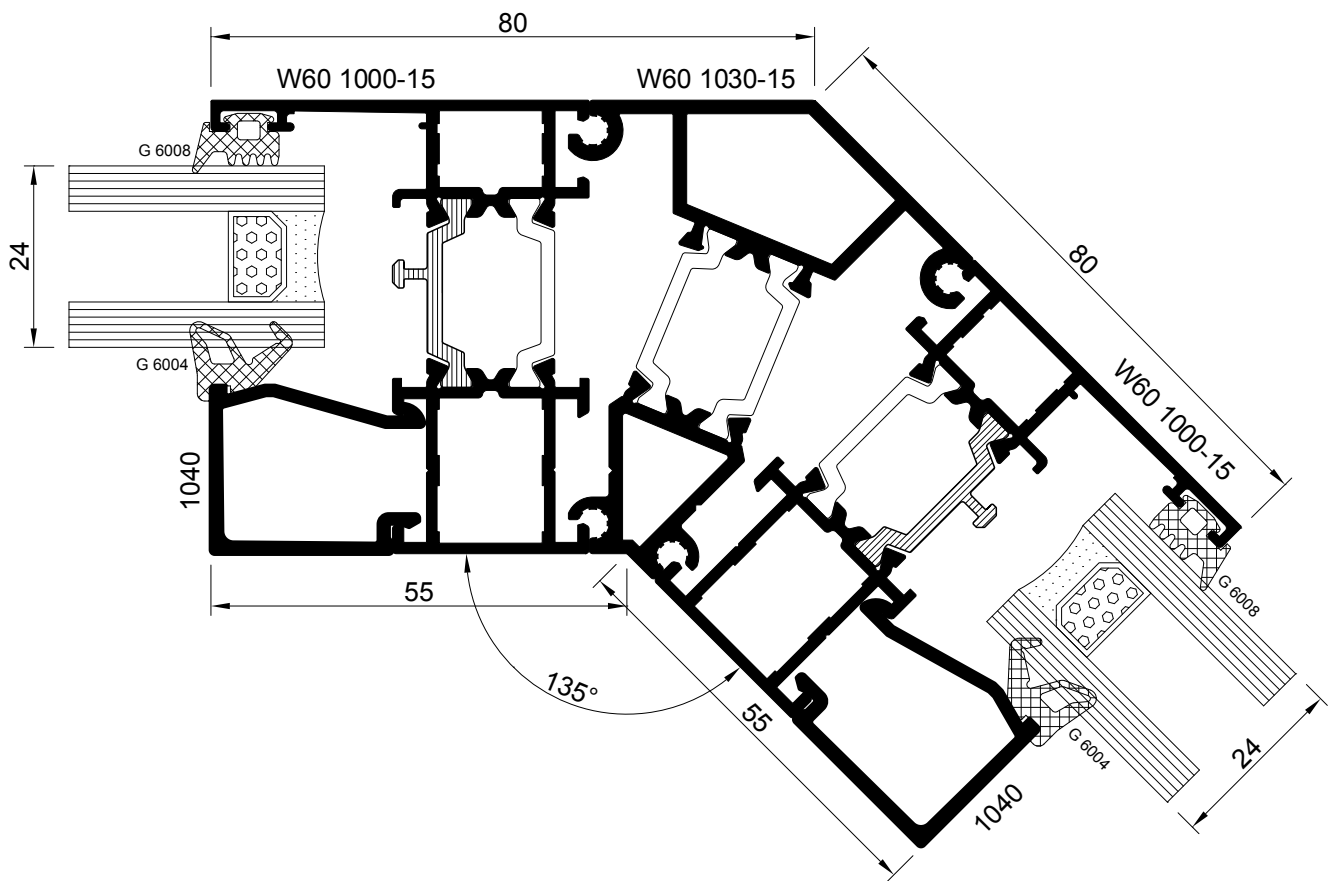

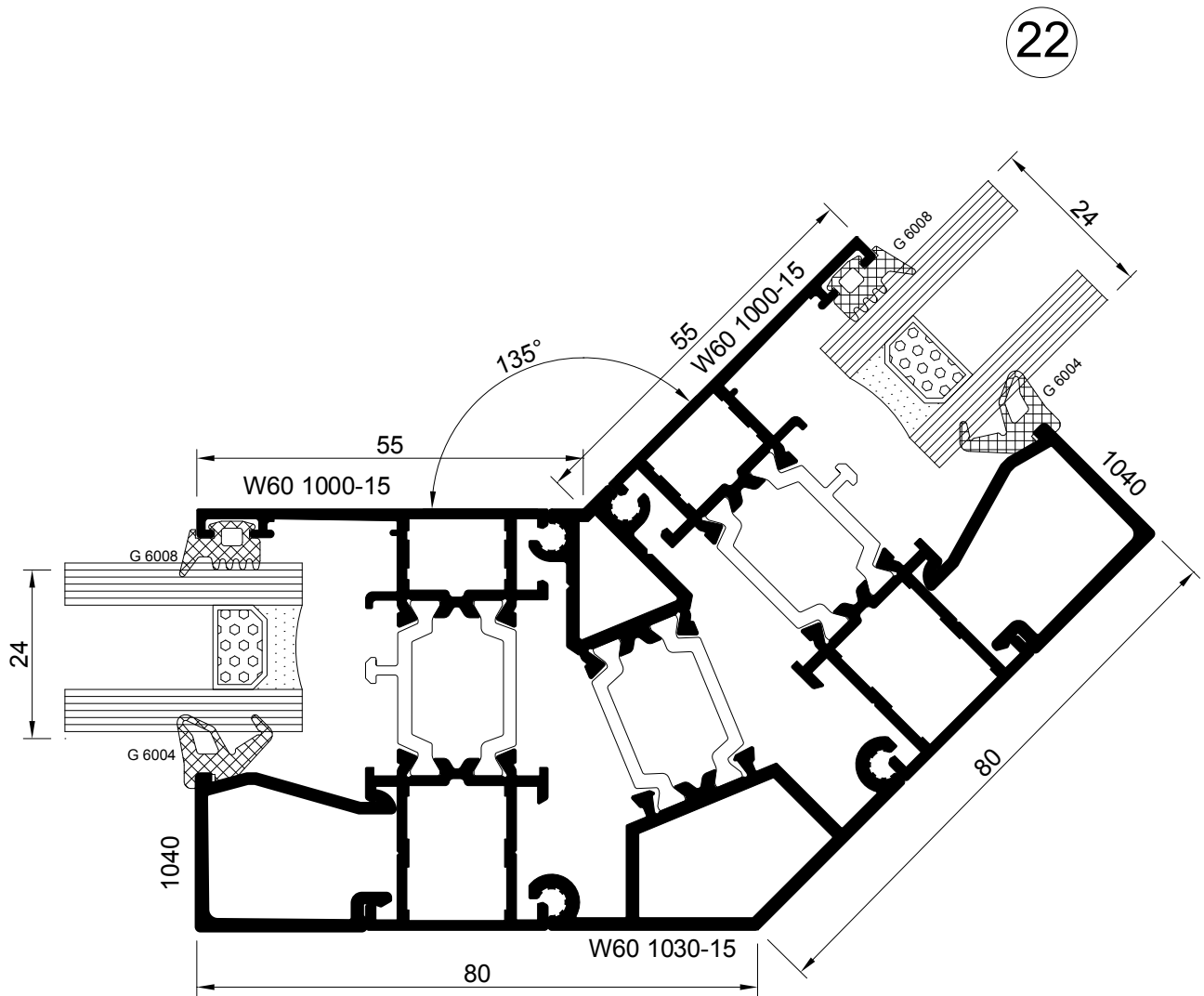
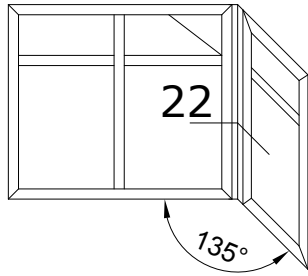

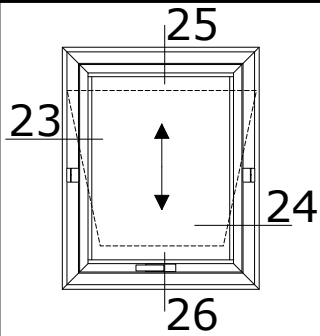

23

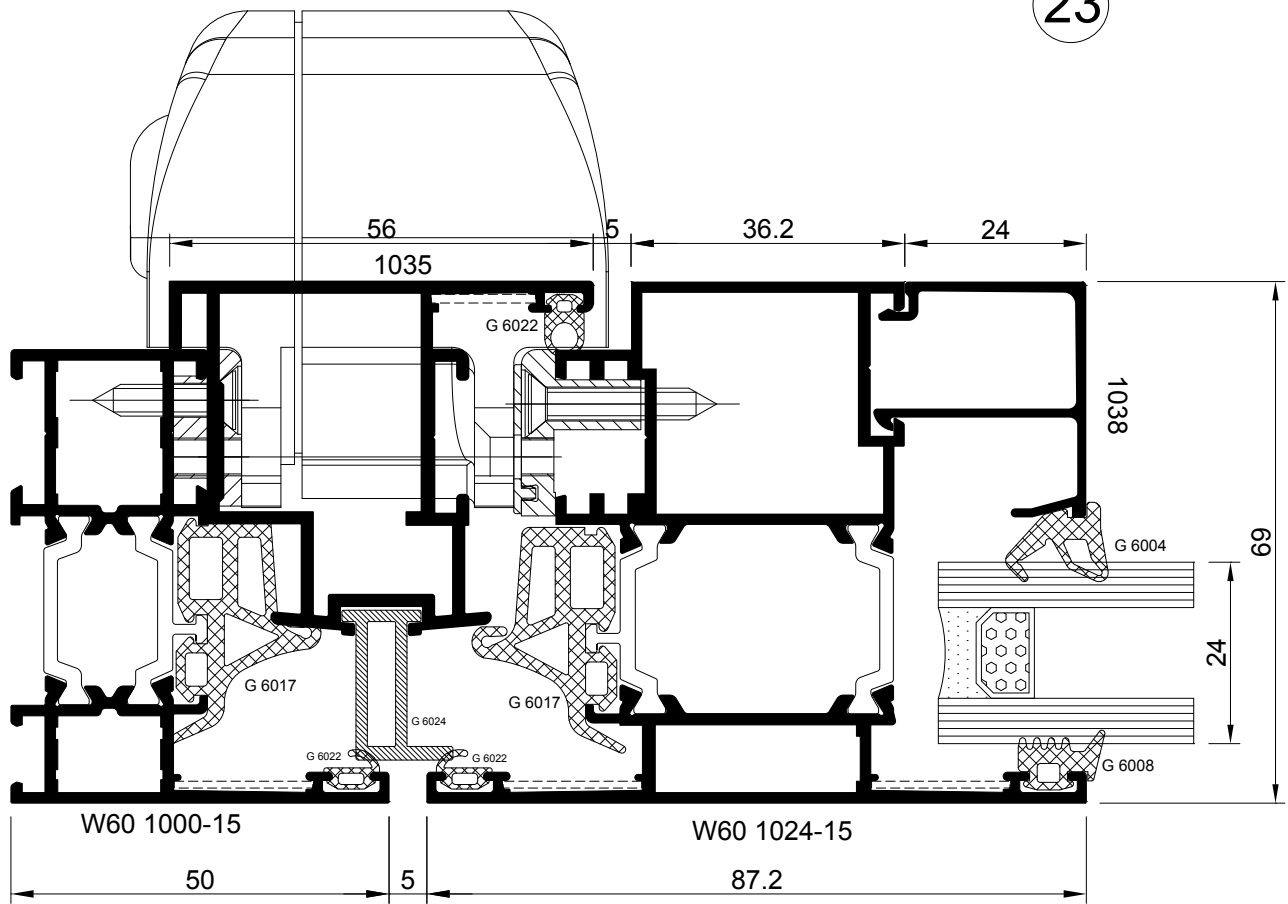

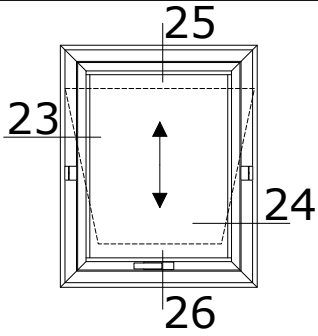

24

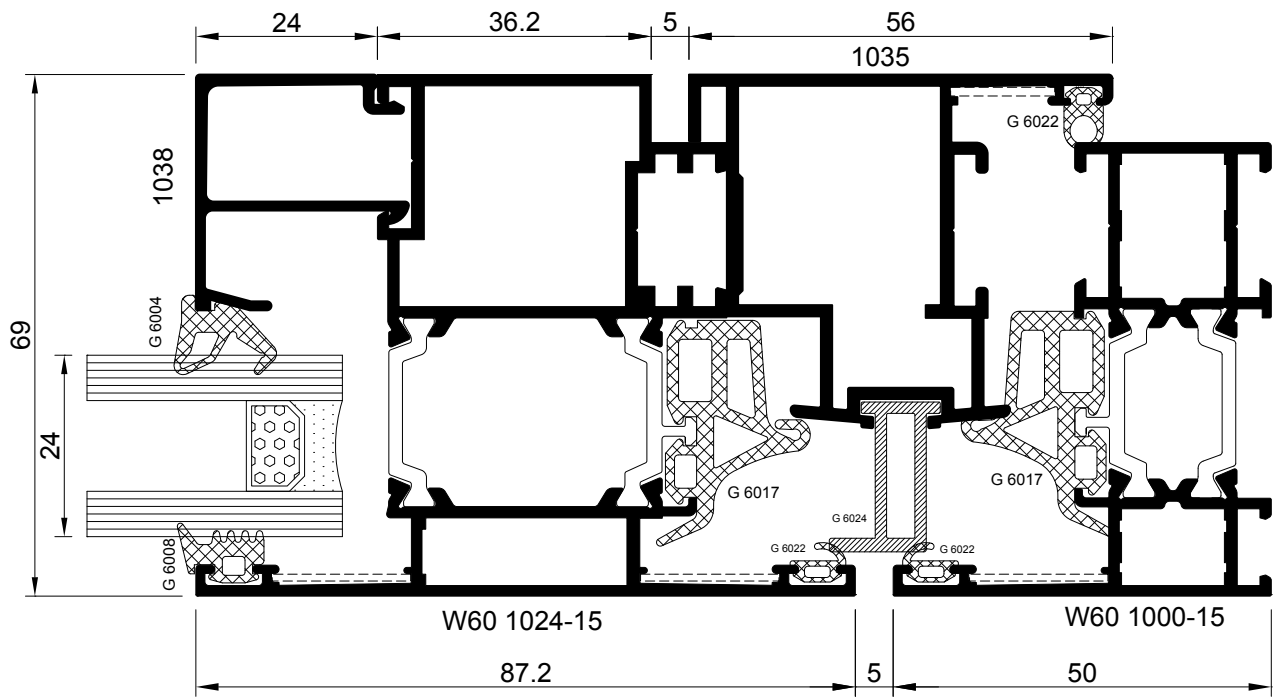

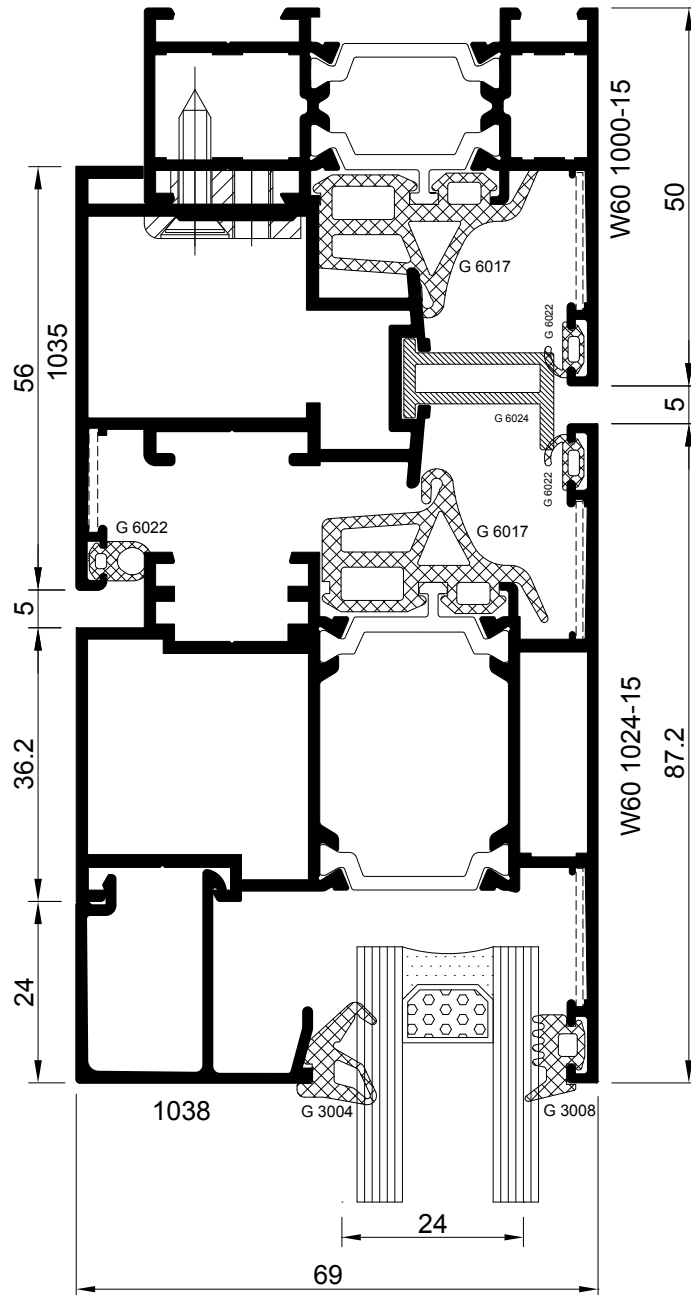
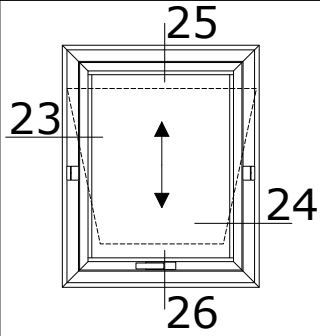

25

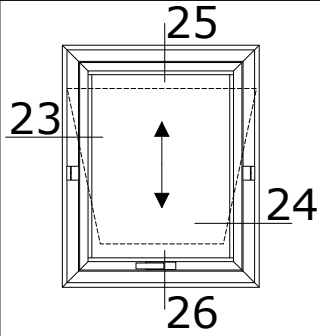

26

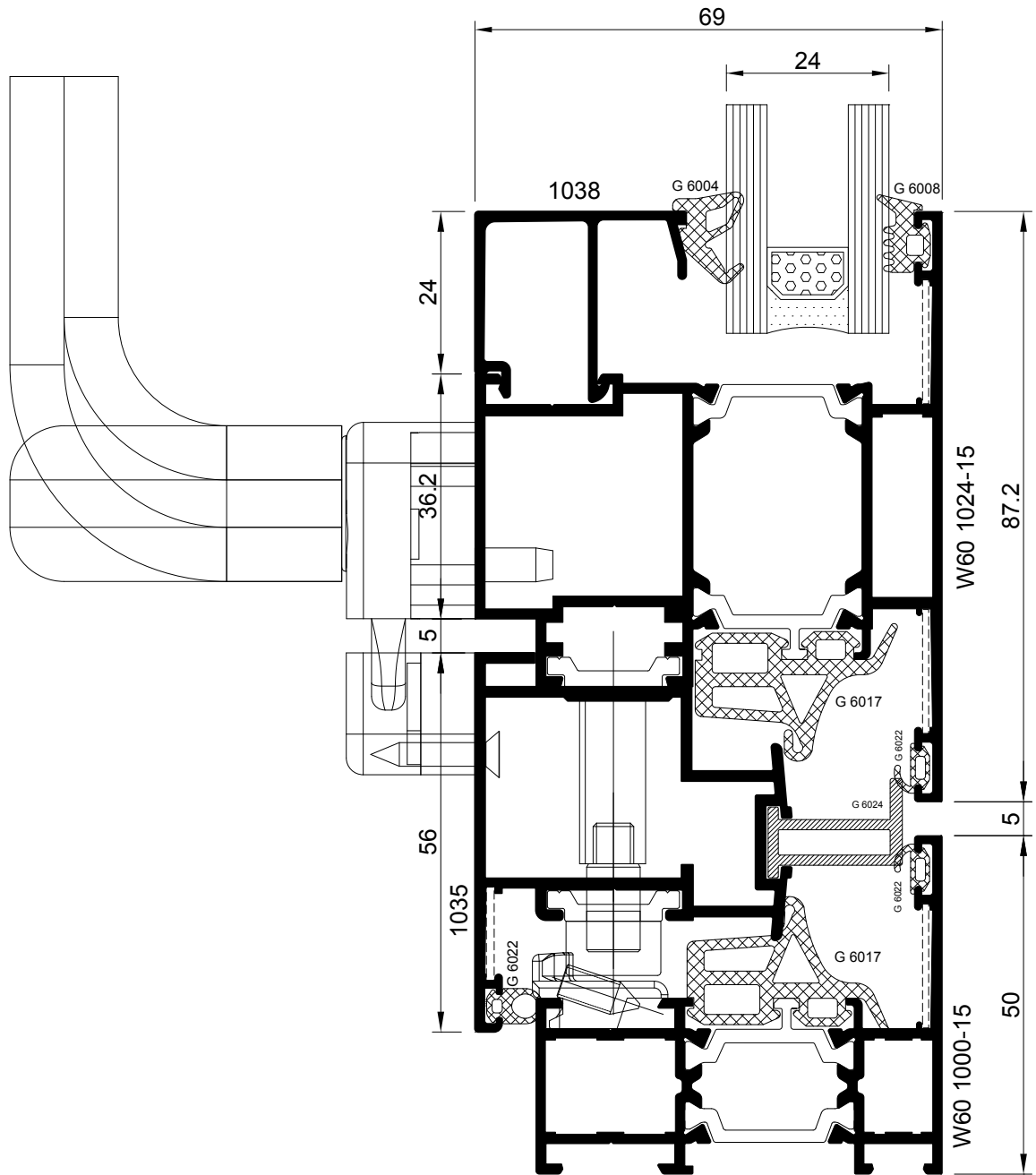

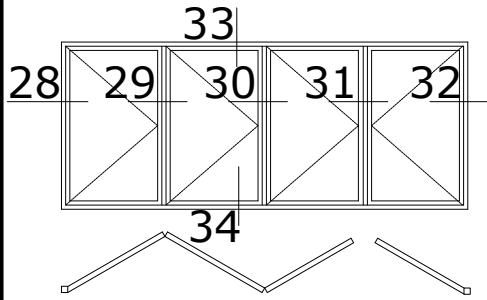

28

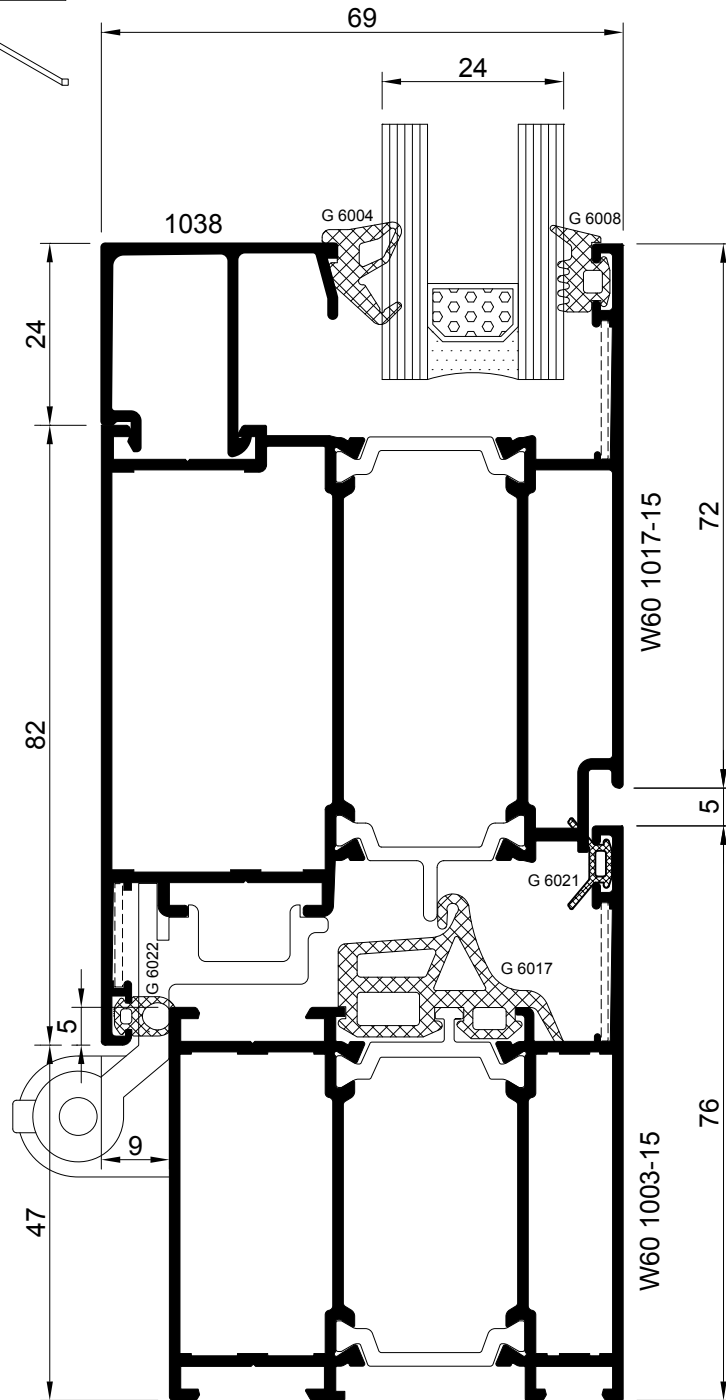

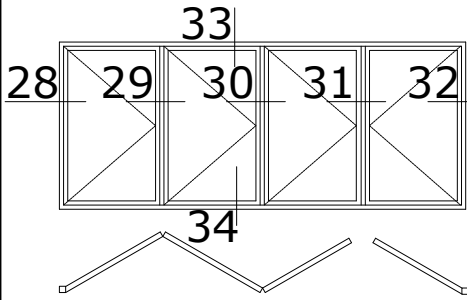

29

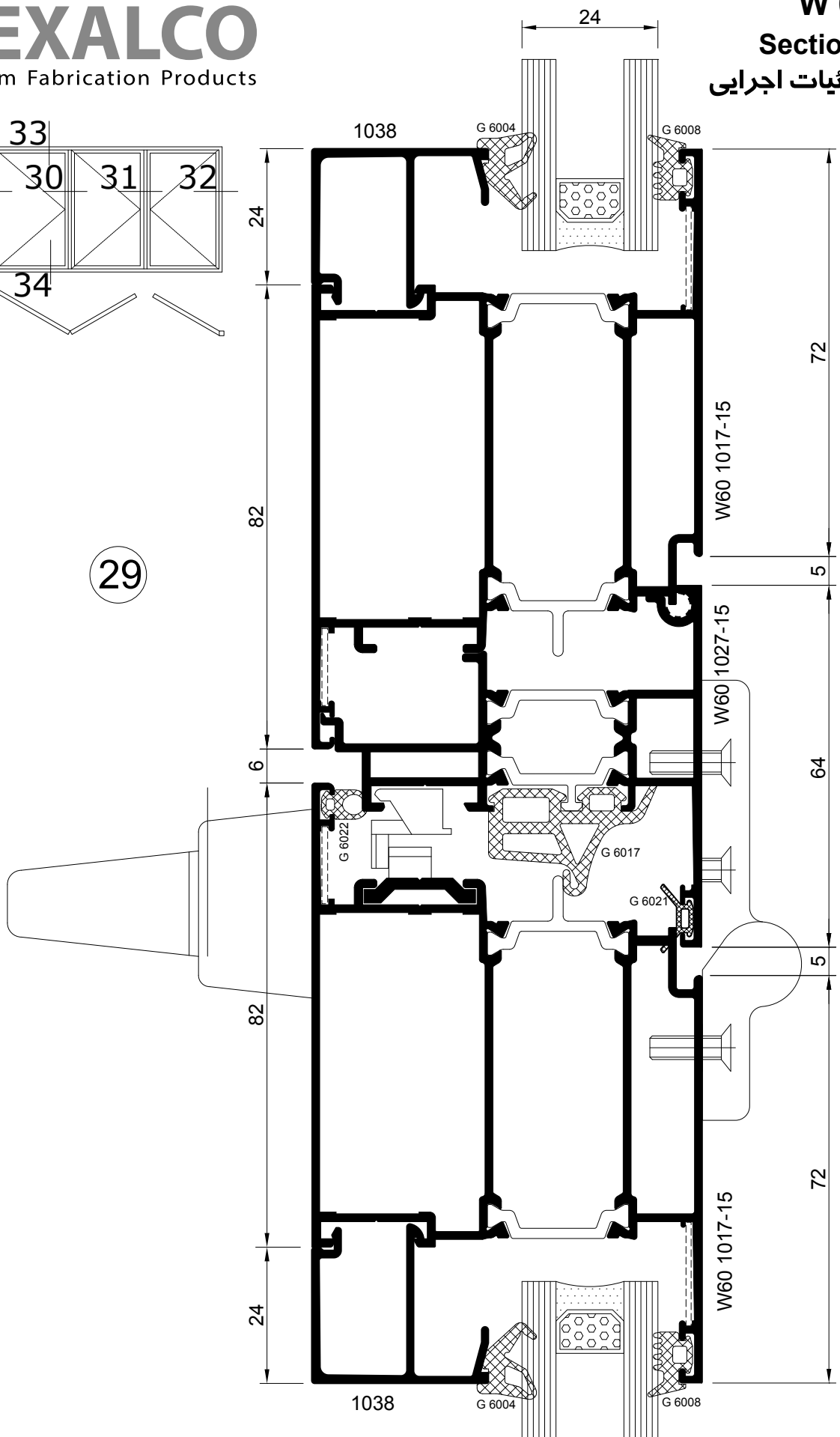

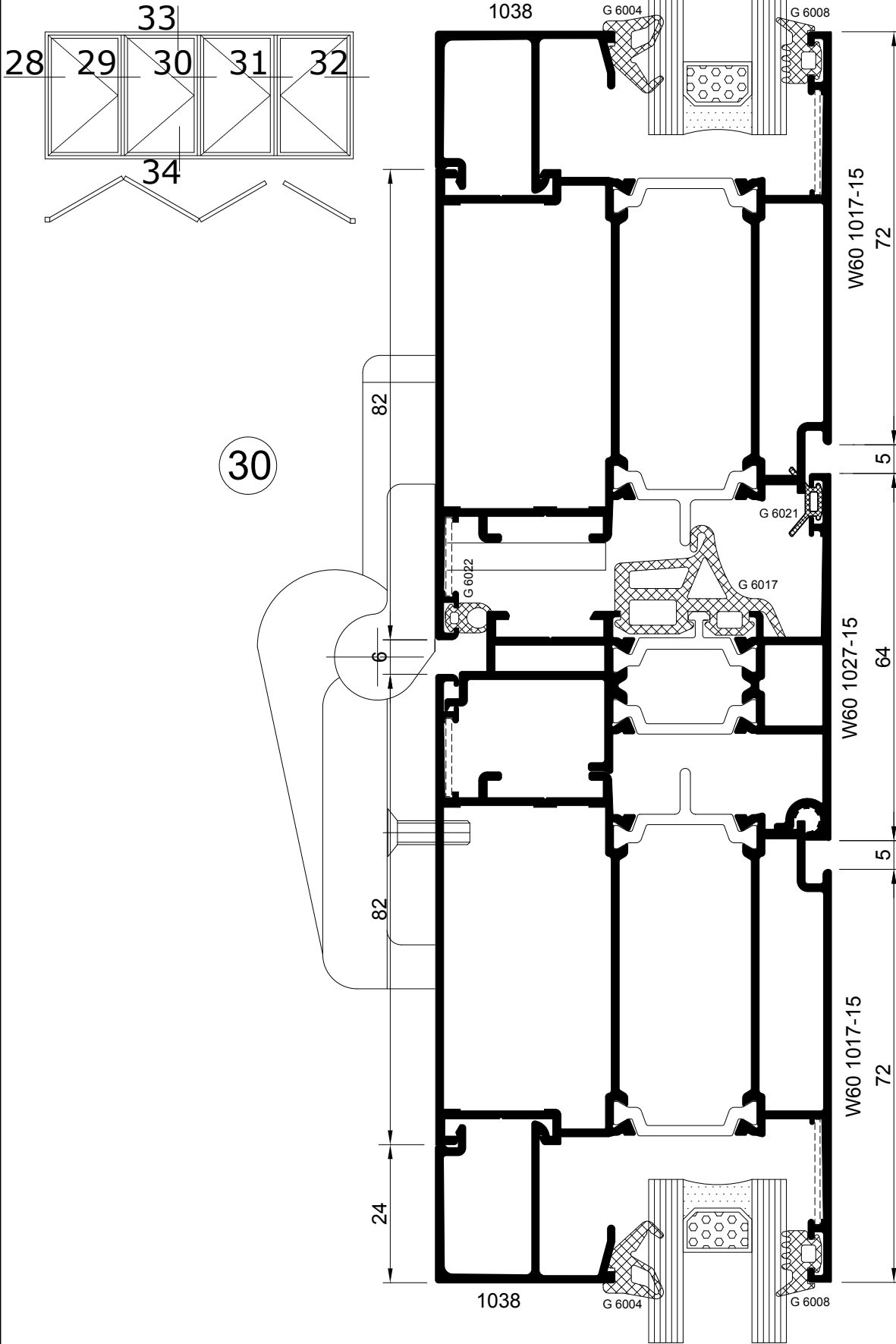

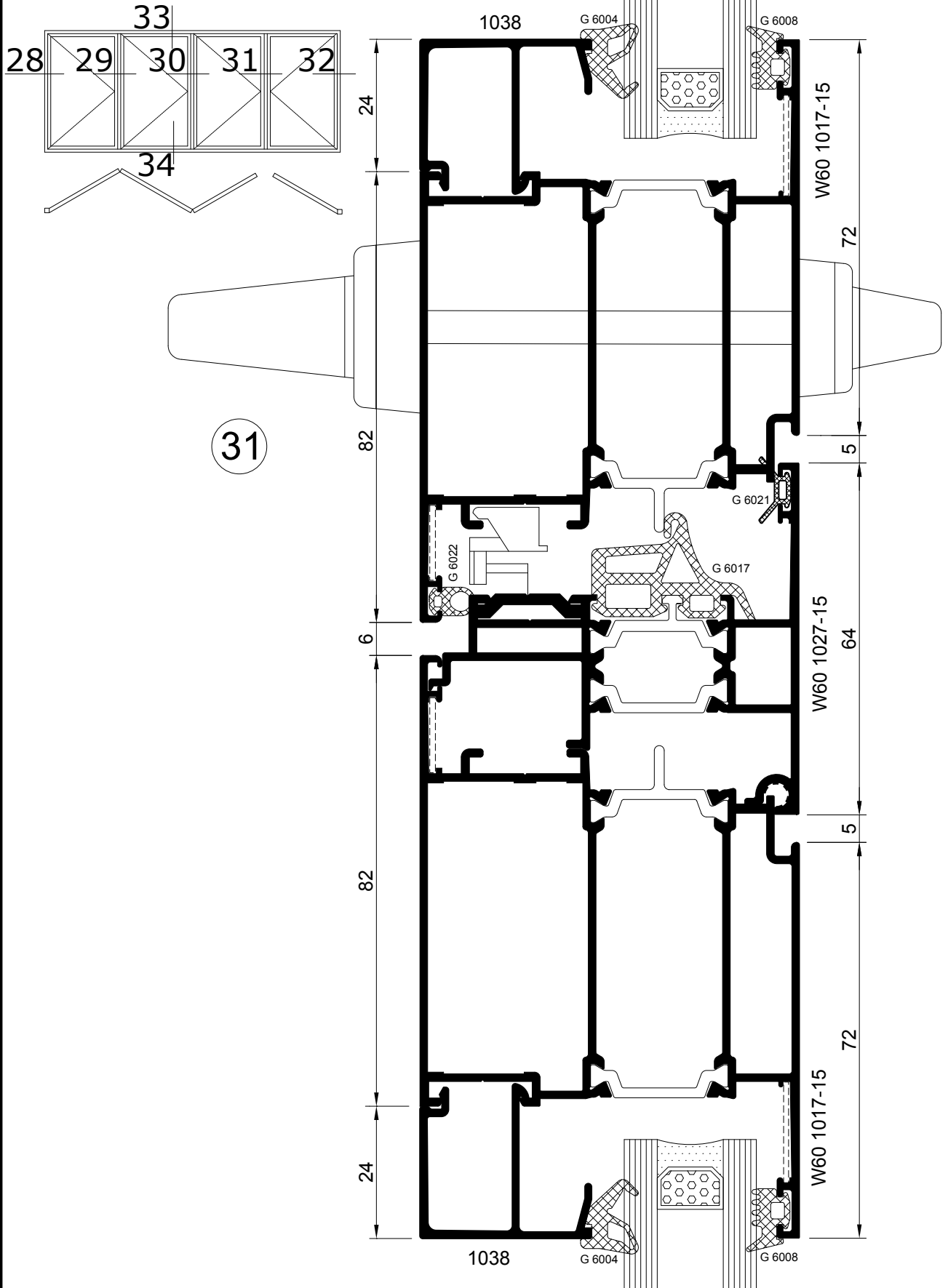

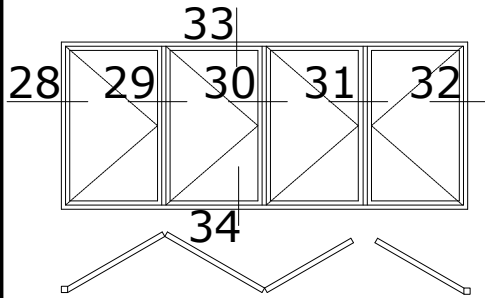

32

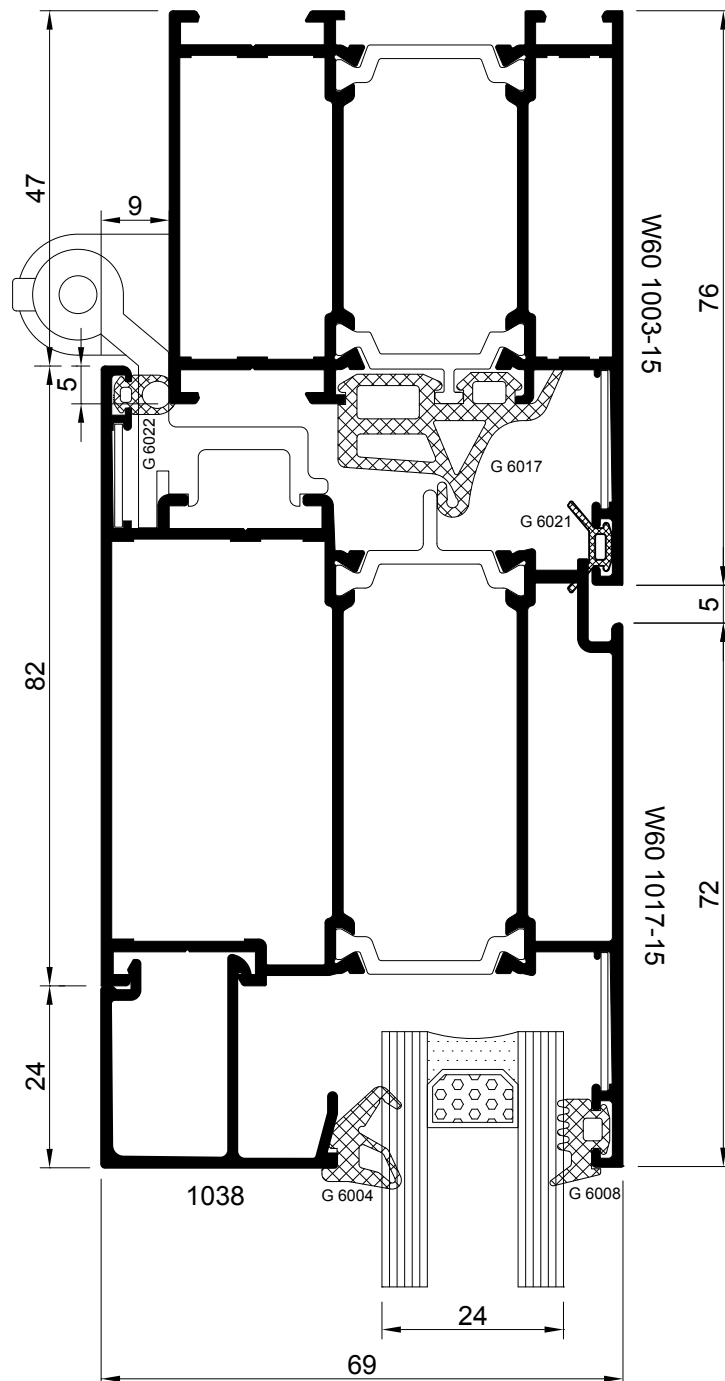

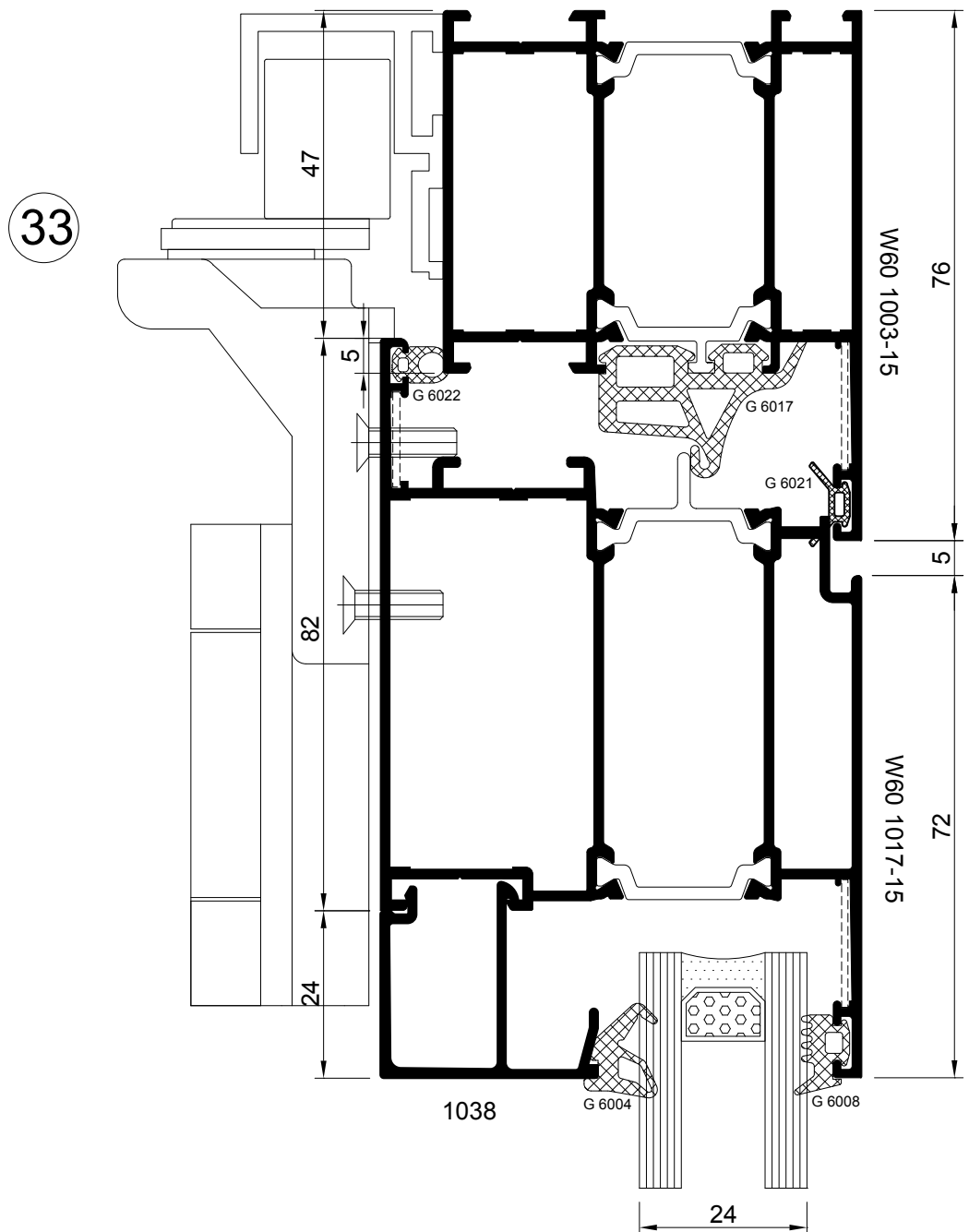
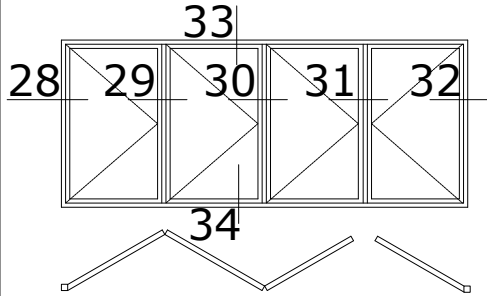

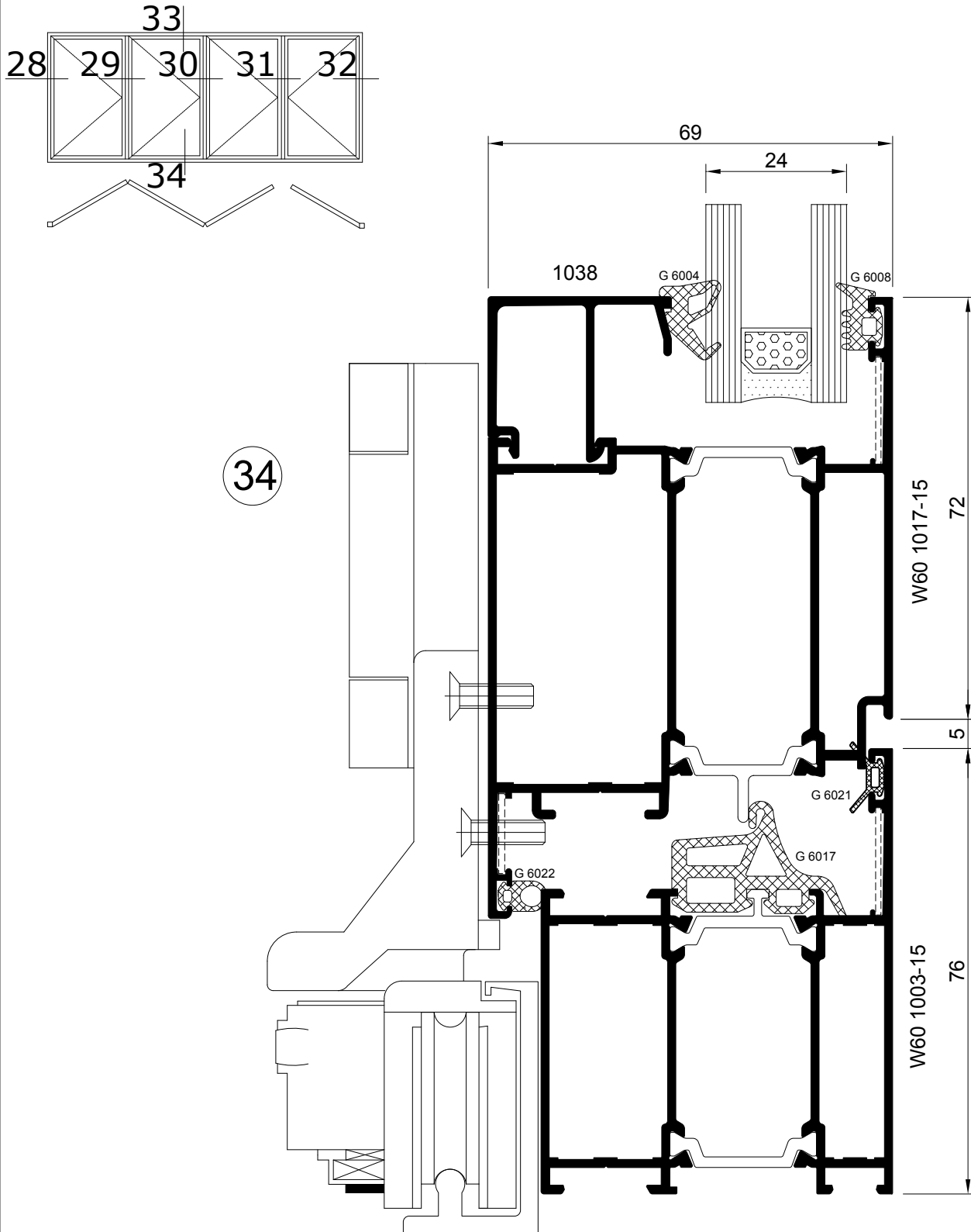

34

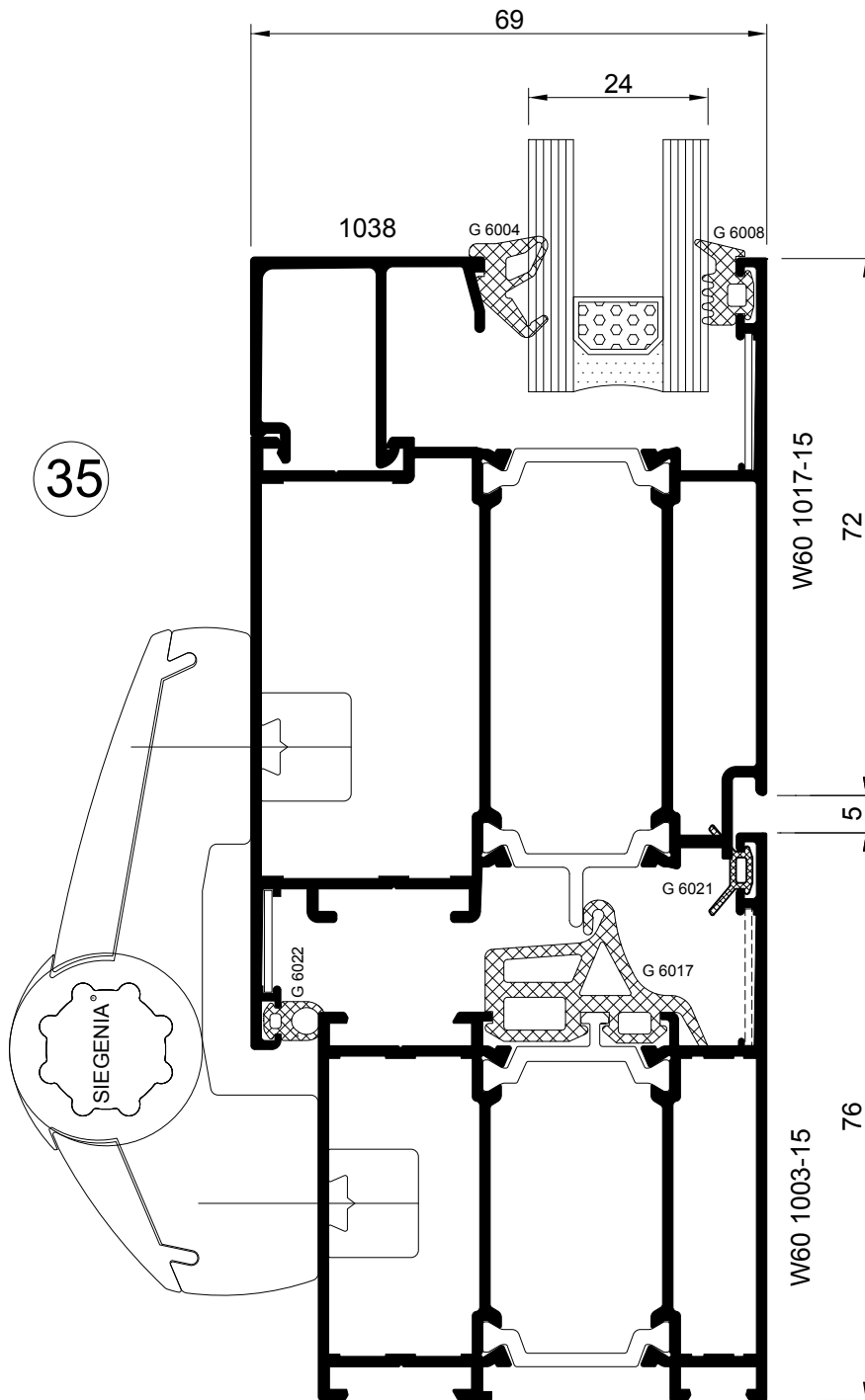
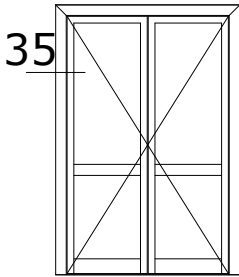

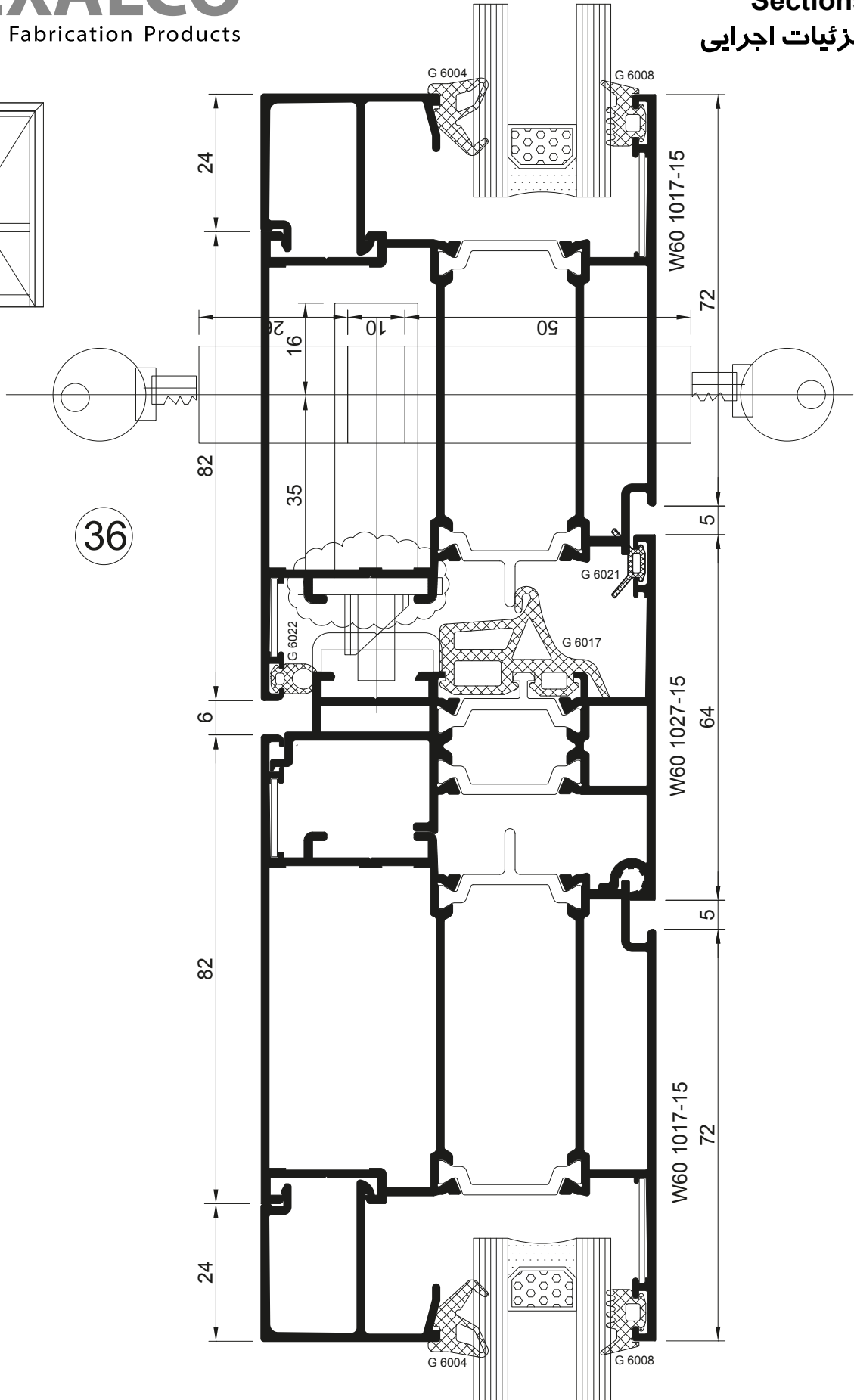
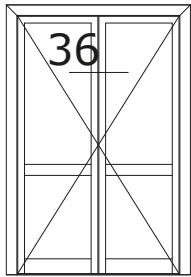

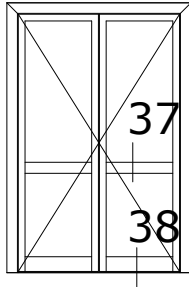

38

37

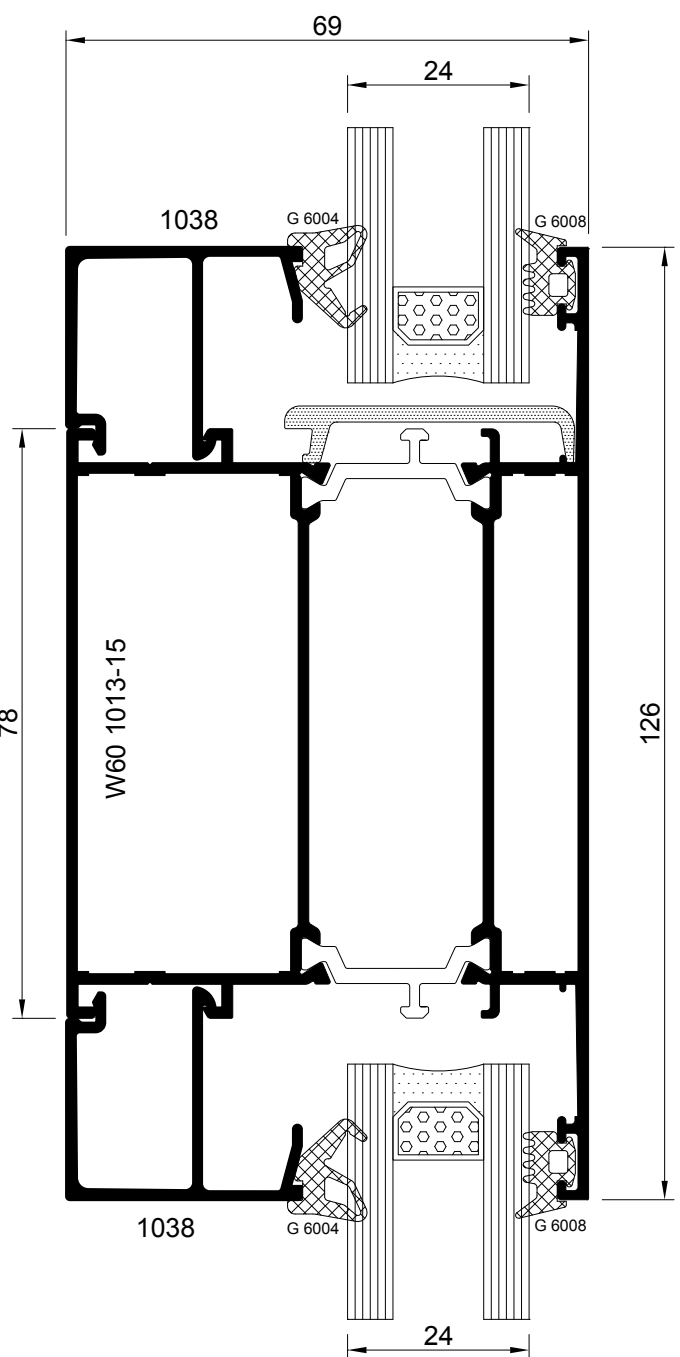
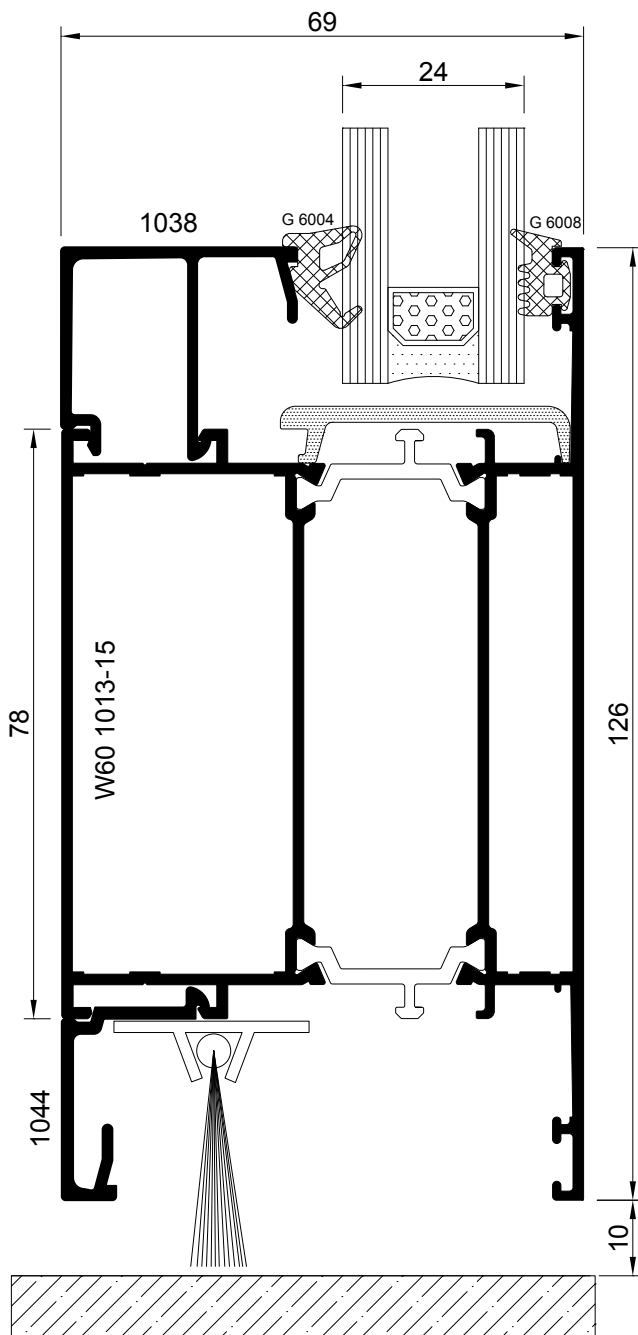



آدرس: زنجان، شهرک صنعتی شماره یک، خیابان پروفیسور ثبوتی، روبروی خیابان آذر جنوبی
تلفن: ۴ - ۳۳۲۲ ۱۲۶۳ - ۰۲۴
نمبر: ۱۲۶۵ - ۳۳۲۲ - ۰۲۴

Add: Professor sabouti St., No.1 Industrial Zone, Zanjan, iran

Phone: +9824 3222 1263 - 4

Fax: +9824 3222 1265

www.exalaluminium.com

info@exalaluminium.com